

金翅鸟冠 GARUDA CORONET P182

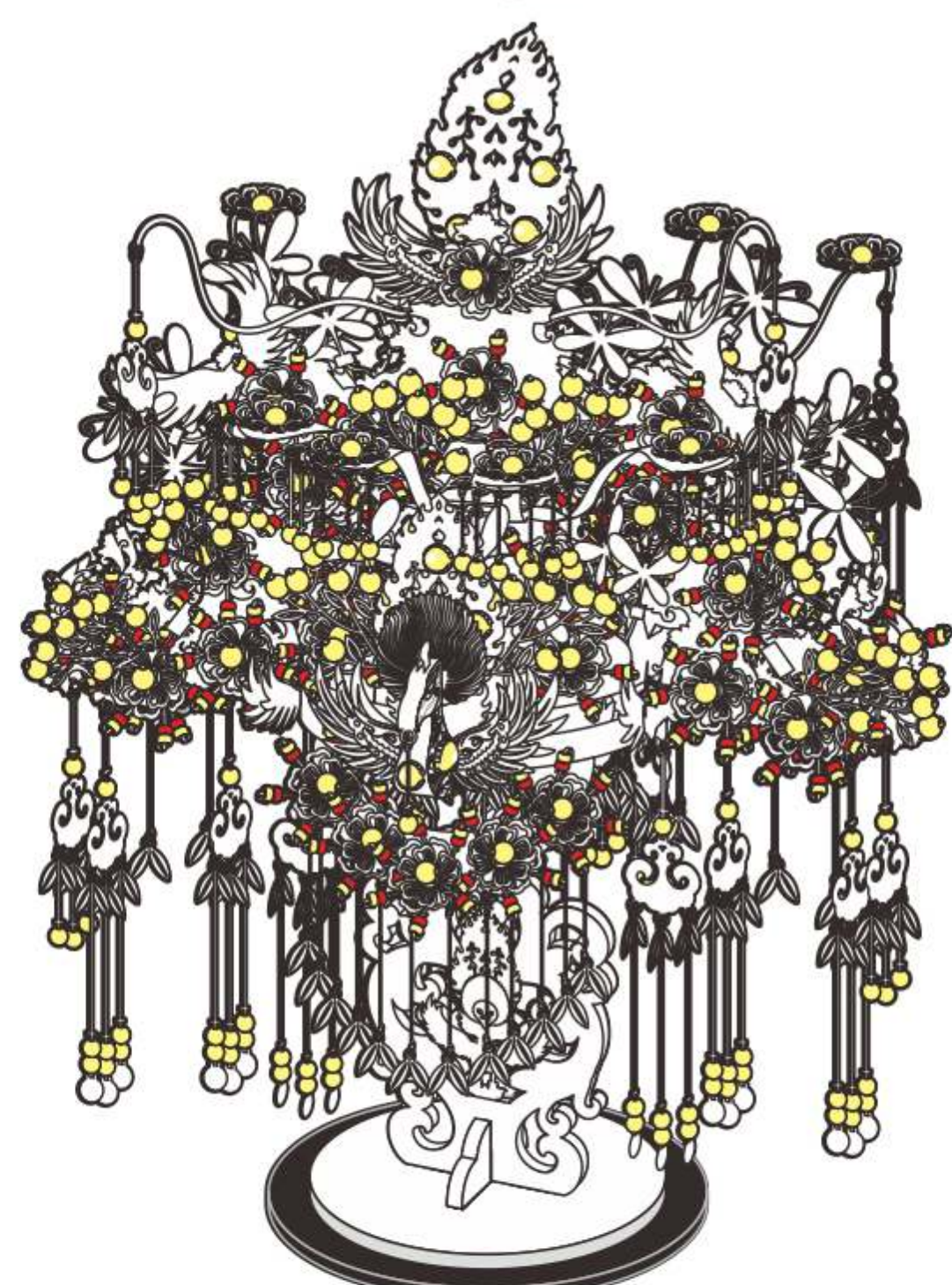

CP-ASSY-P182#-A3-20210806
电子版下载地址: <http://www.piececool.com/cpsuoming/P182.pdf>

拼前需知

• 准备工具:

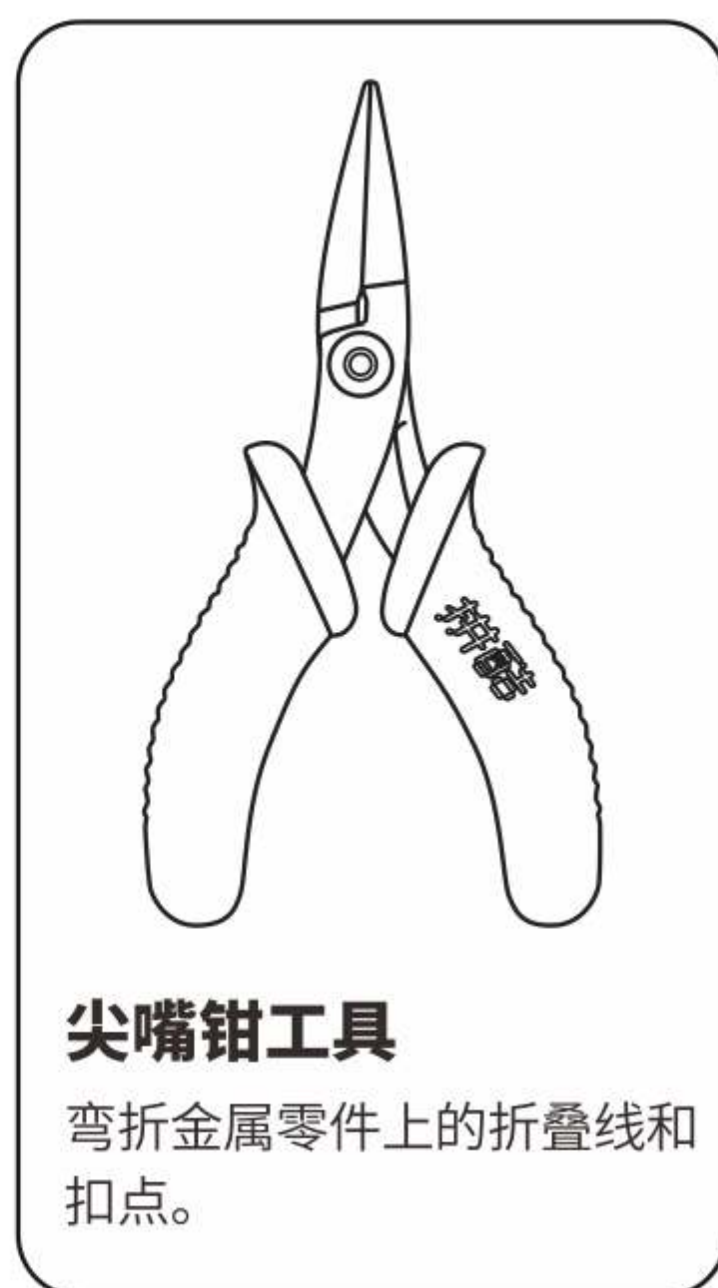
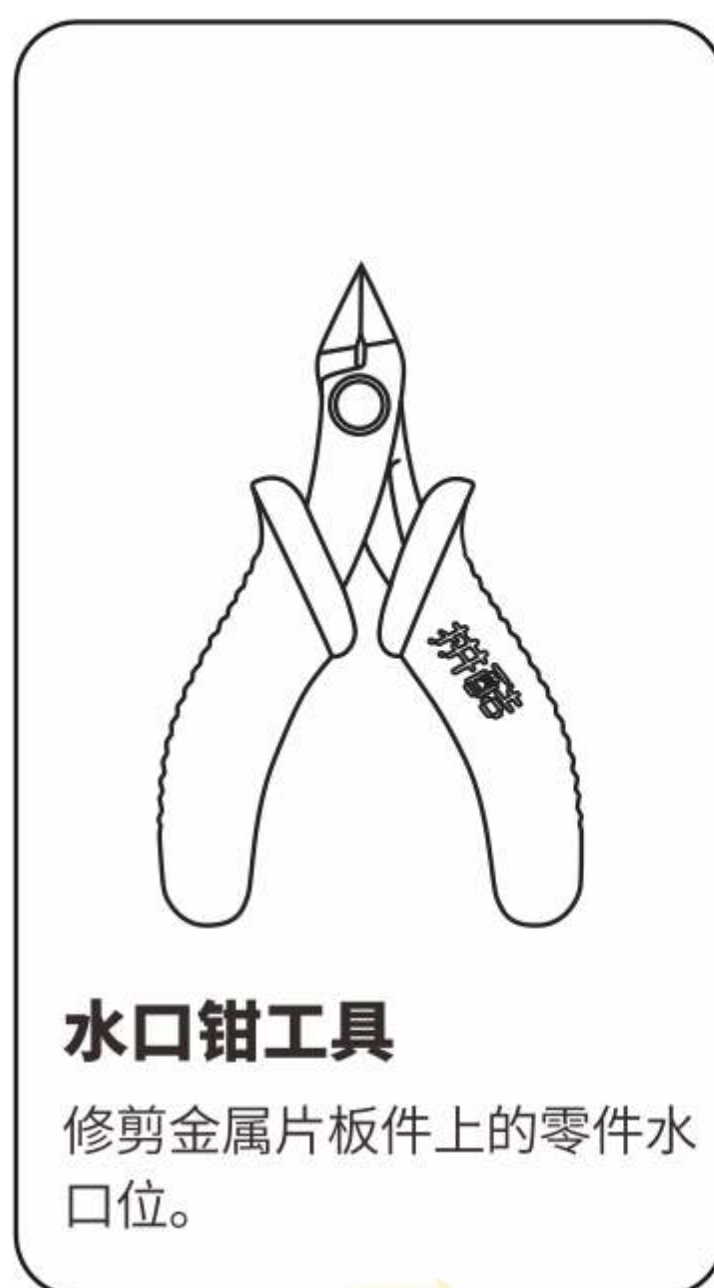

建议使用拼酷正品拼装工具(水口钳、尖嘴钳),拼装时更省心、省力,拼装后作品更精细、美观!

⚠️ 组装时请小心处理金属零件,以防划伤

• 拼装方法:

a. 取下零件:



使用水口钳剪断金属零件上的水口,将需要的金属零件从金属片板件取下

b. 识别零件:



识别金属零件上的扣点,折叠线,扣孔的样子

c. 折叠零件:

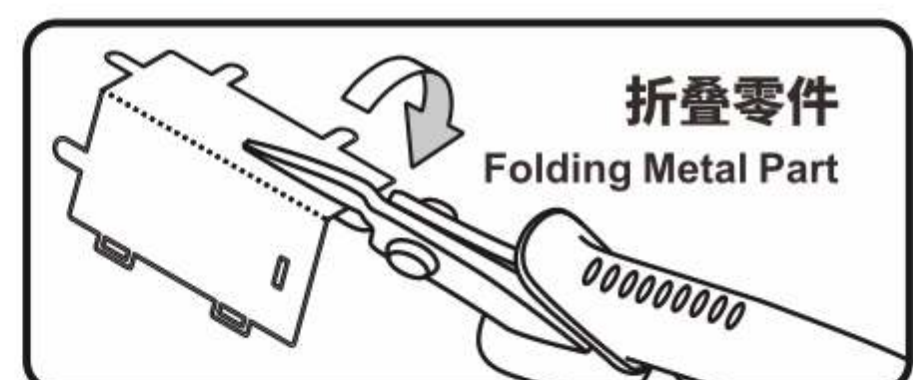

使用尖嘴钳,参照拼装说明书将金属零件折成形状

d. 固定零件:



● 插入扣孔,平折90°



▲ 插入扣孔,旋转90°

• 注意事项:



剪金属零件时请剪零件“水口位”,请勿将“扣点”当成“水口位”剪下,每次剪零件时请仅剪当前步骤的零件,切勿一次性将所有零件全部剪下,避免丢失;
当遇到折叠线的零件,请注意金属片的正反面及拼折方向,请按照说明书的方向,轻剪慢折,最好一次性折叠完成,请勿反复折叠,避免零件损坏。

© Dongguan Weishi Culture Technology Co., Ltd. All rights reserved.

拼装步骤

珠子可根据玩家喜欢的颜色另行购买

Step 01

D-1 (纹)
AC E-3 (纹)
DE-4 (纹)
BCD E-2 (纹)

2号红色珠子 × 6
1号透明珠子 × 6

3号大白色珠子 × 45

Step 02

A-6 (纹)
ABC-5 × 8 (纹)

A-7 (纹)
A-8 (纹)

Step 01 × 14

背面

A-9 (纹)

Step 03

AB-10 (纹)
C-11 (纹)

4号半个白色珠子 × 5

Step 04

AC E-3 (纹)
BCD E-2 (纹)
DE-4 (纹)

不需要固定零件
3号大白色珠子 × 10

Step 05

C-12 (纹)

Step 04 × 4
Step 02

Step 03

Step 06

A-14 (纹)
A-15 (纹)
A-13 (纹)

Step 04

Step 07

B-17 (纹)
B-18 (纹)
AB-16 (纹)

× 4

Step 08

C-19 (纹)

3号大白色珠子 × 18
× 2

Step 09

ABC-5 × 4 (纹)
A-20 (纹)

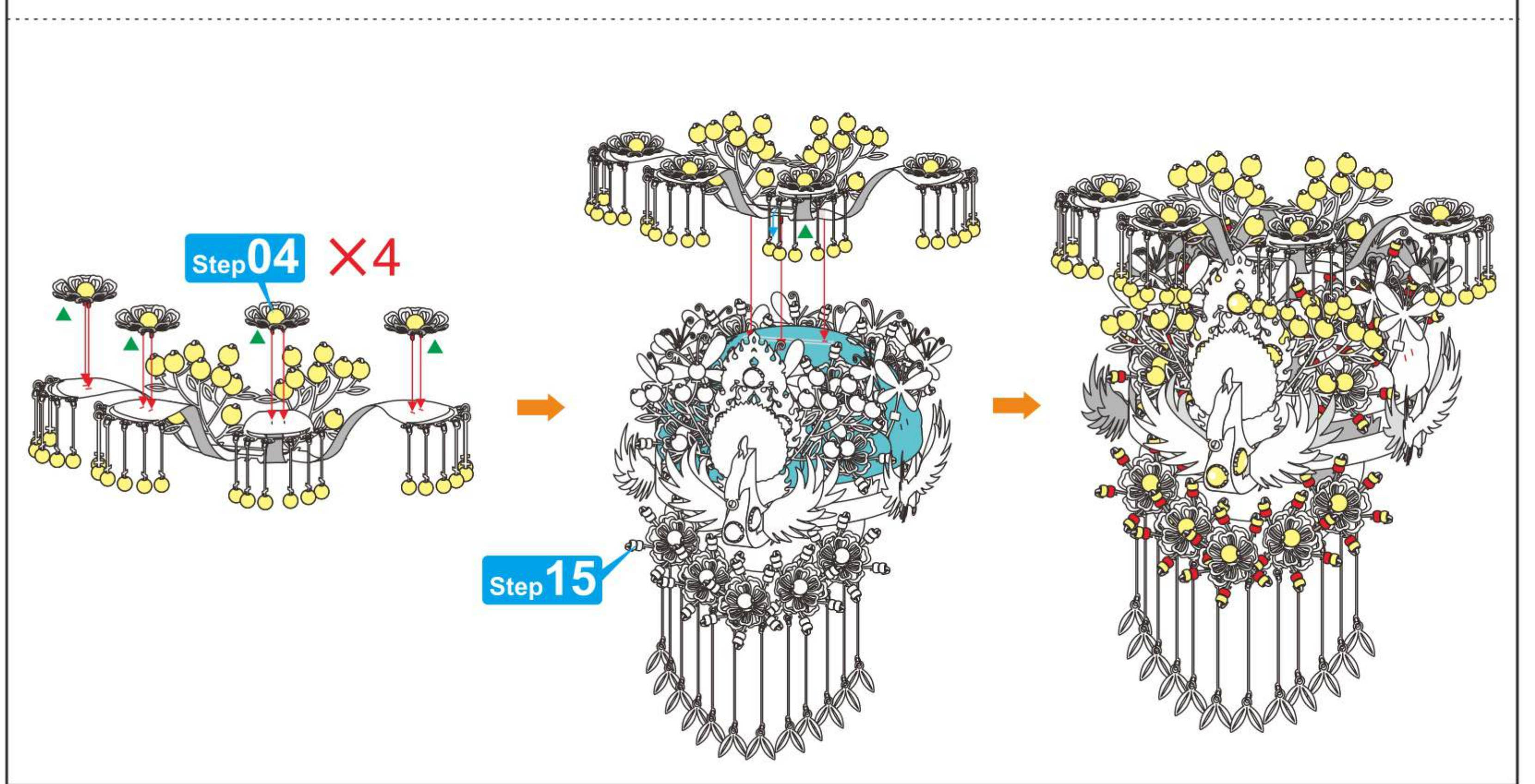
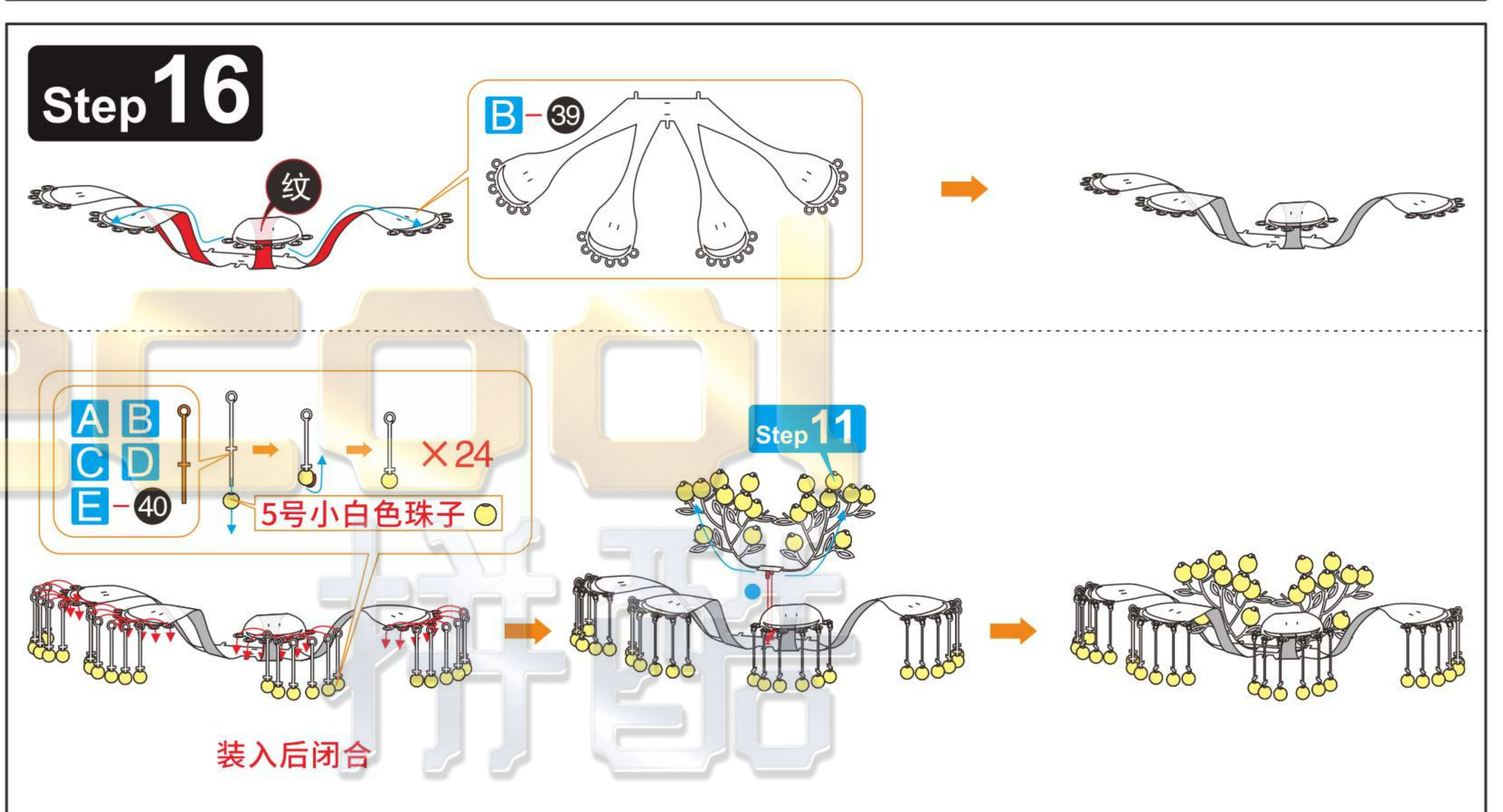
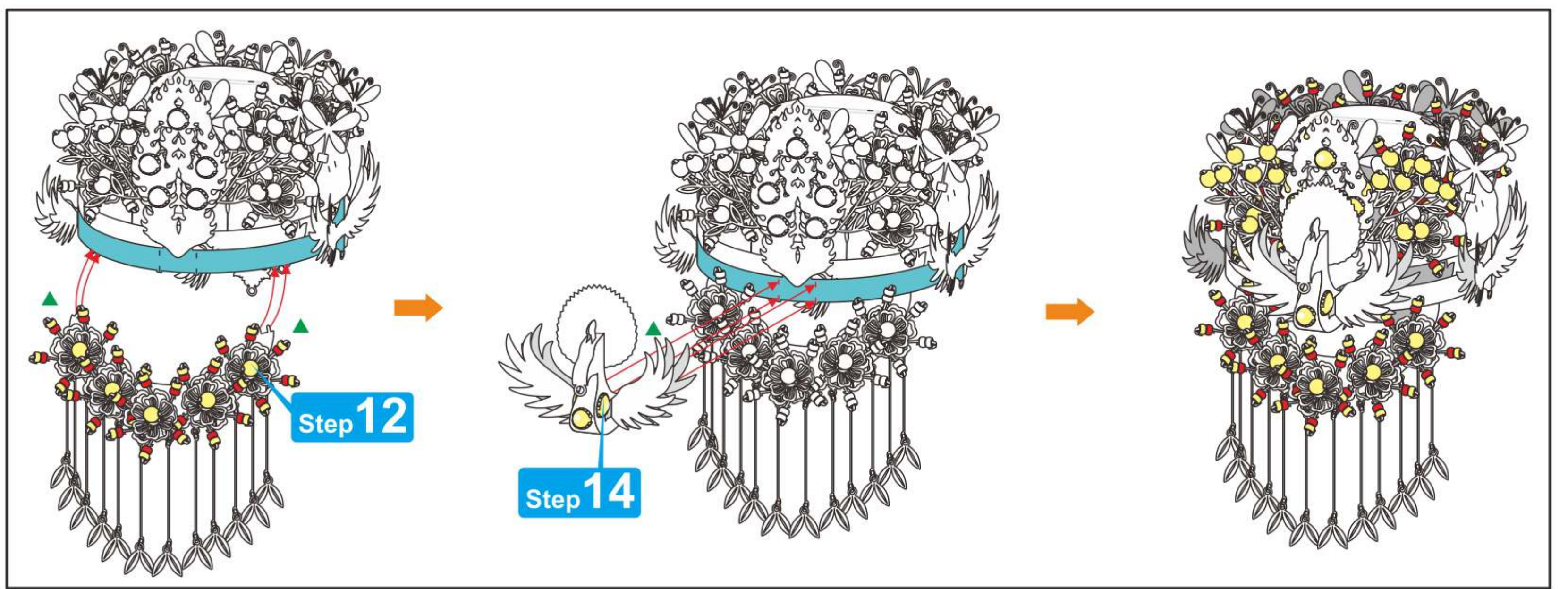
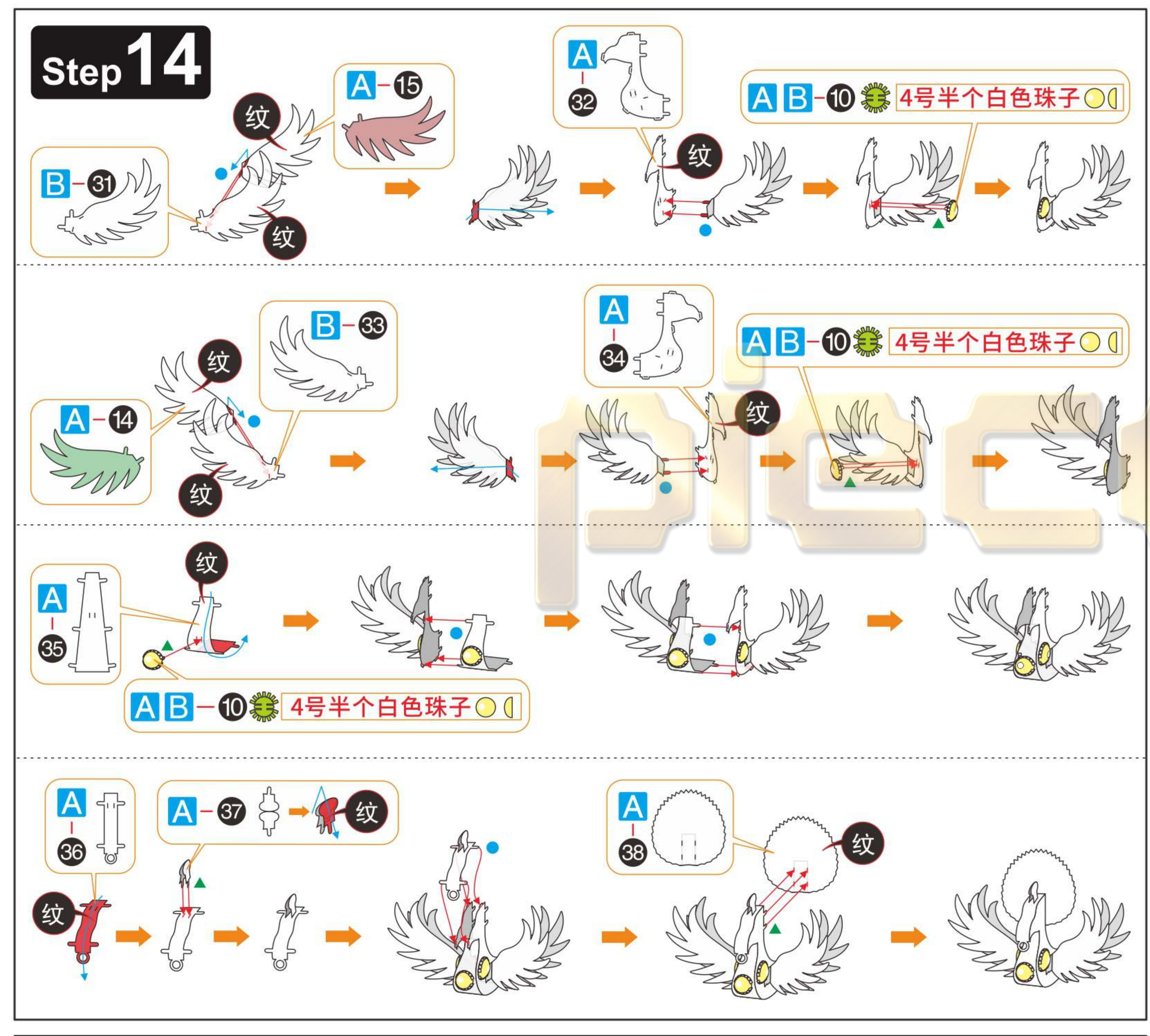
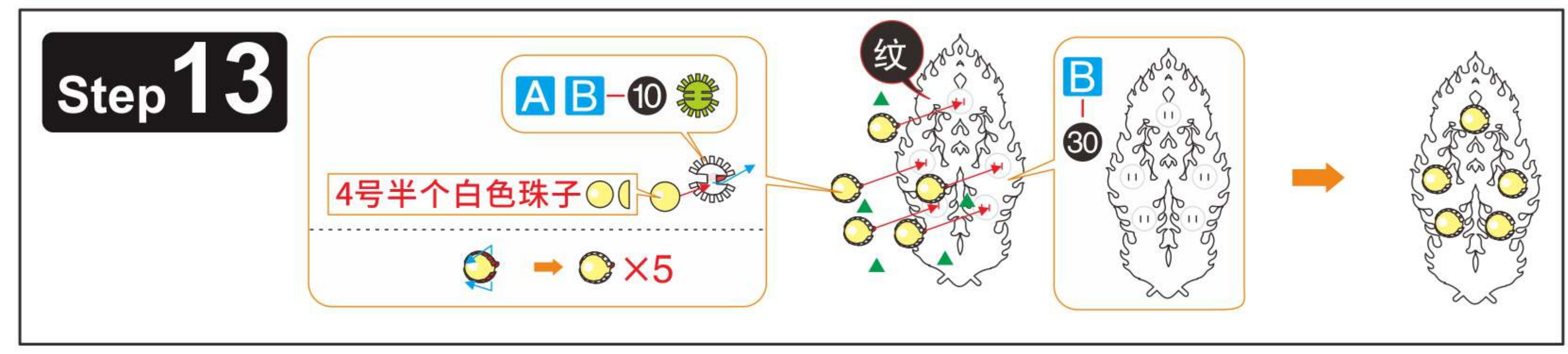
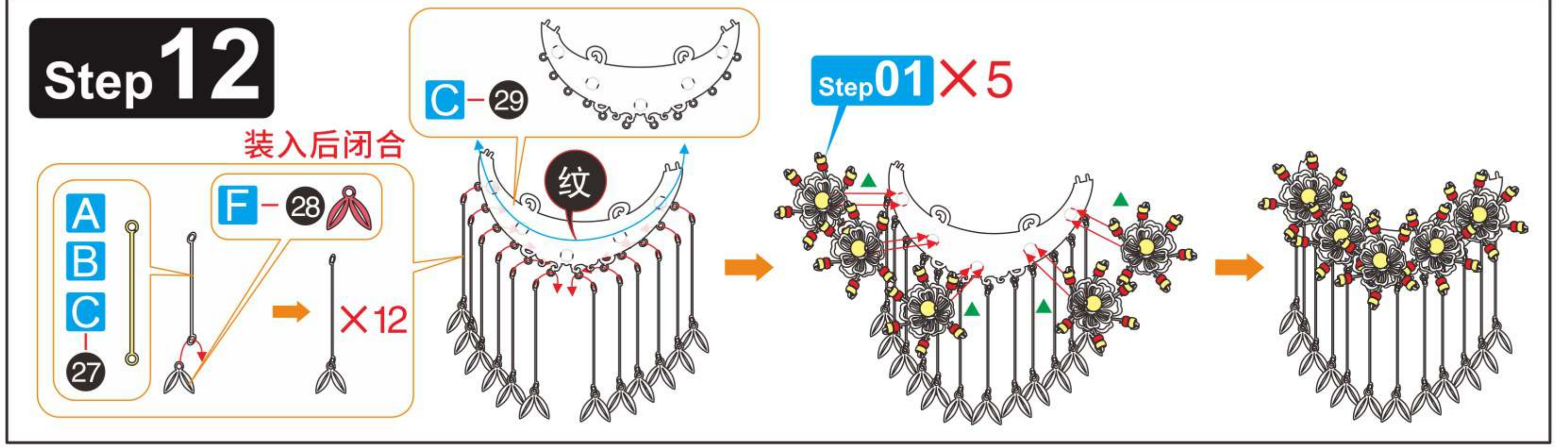
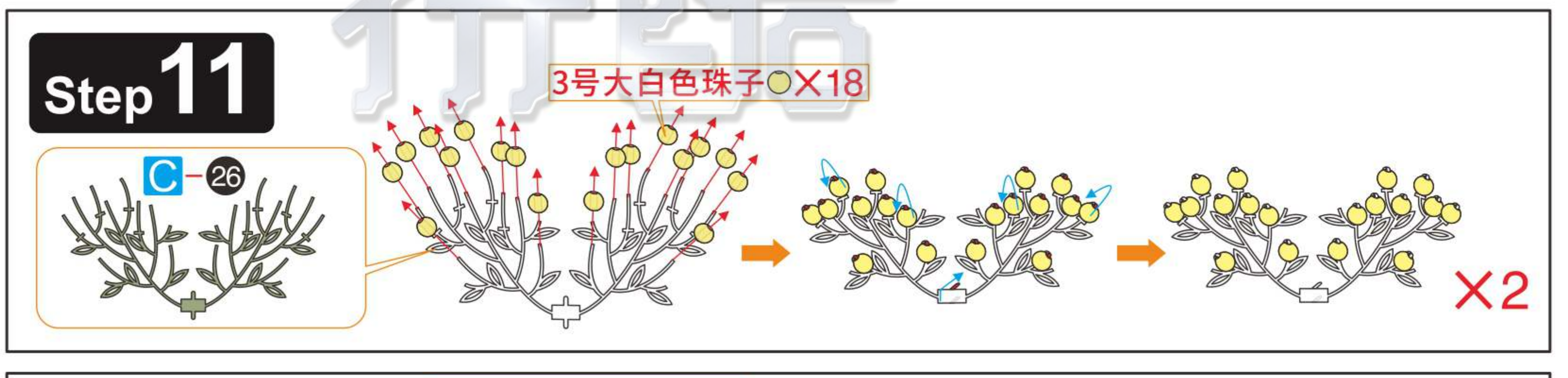
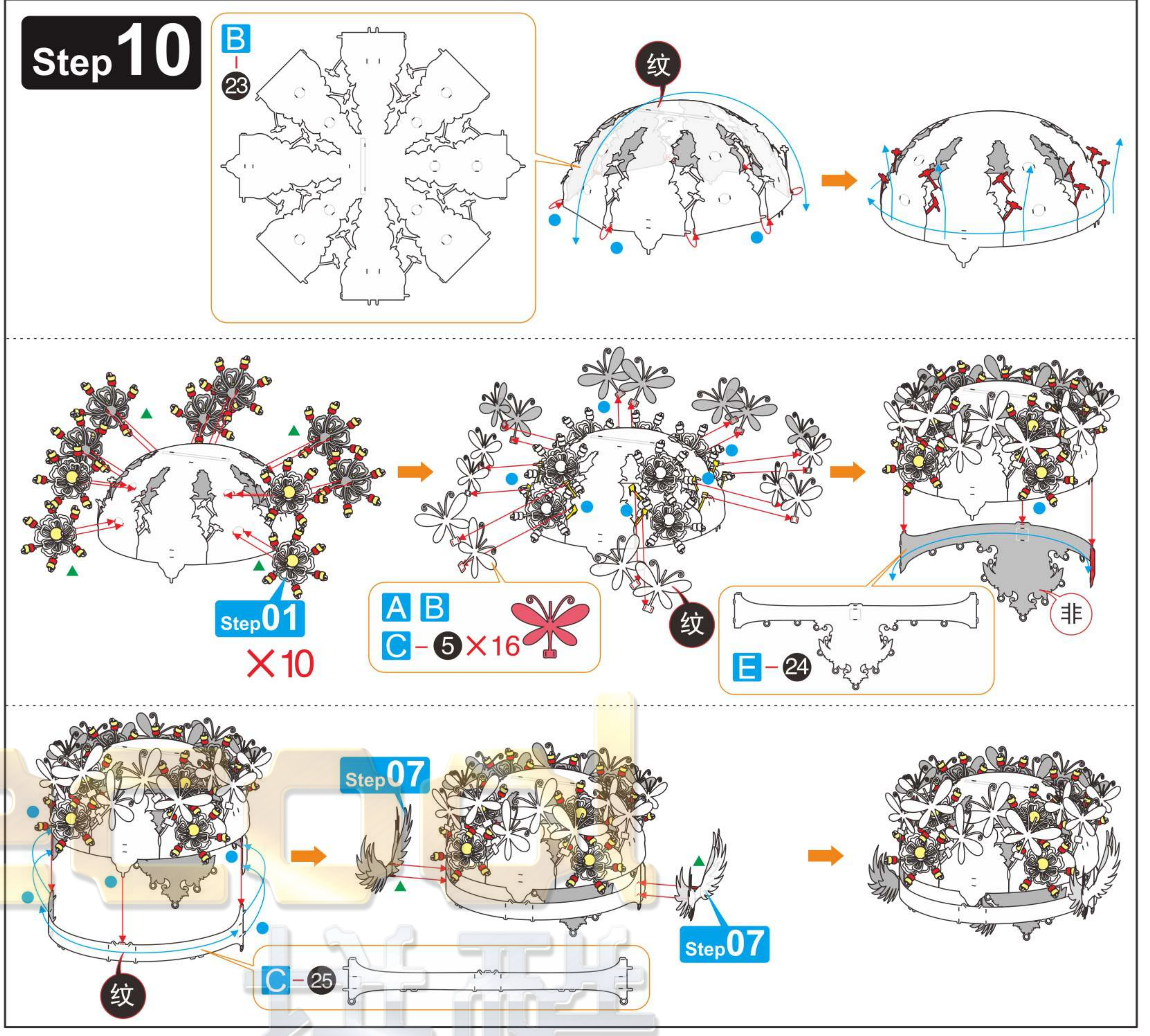
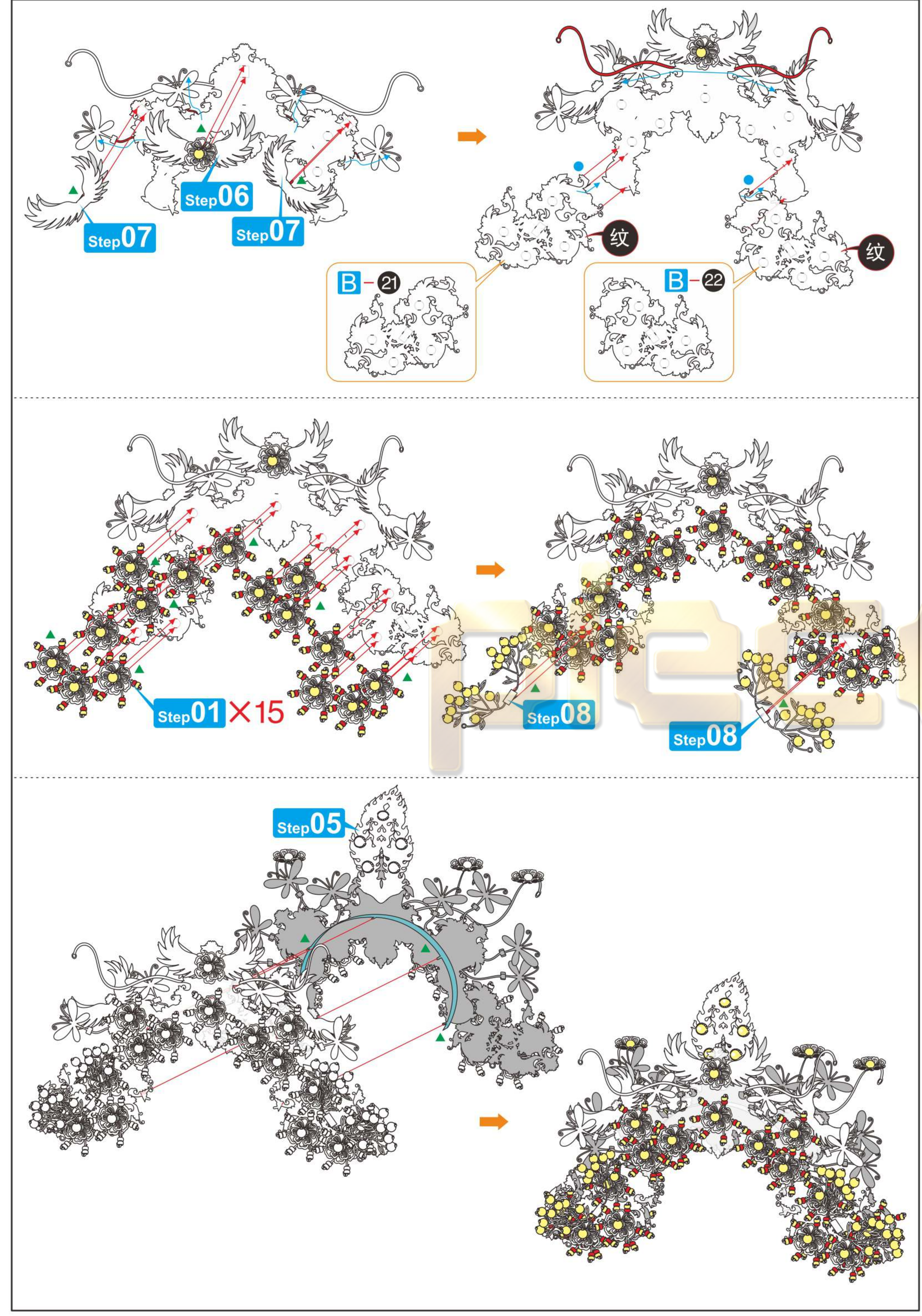

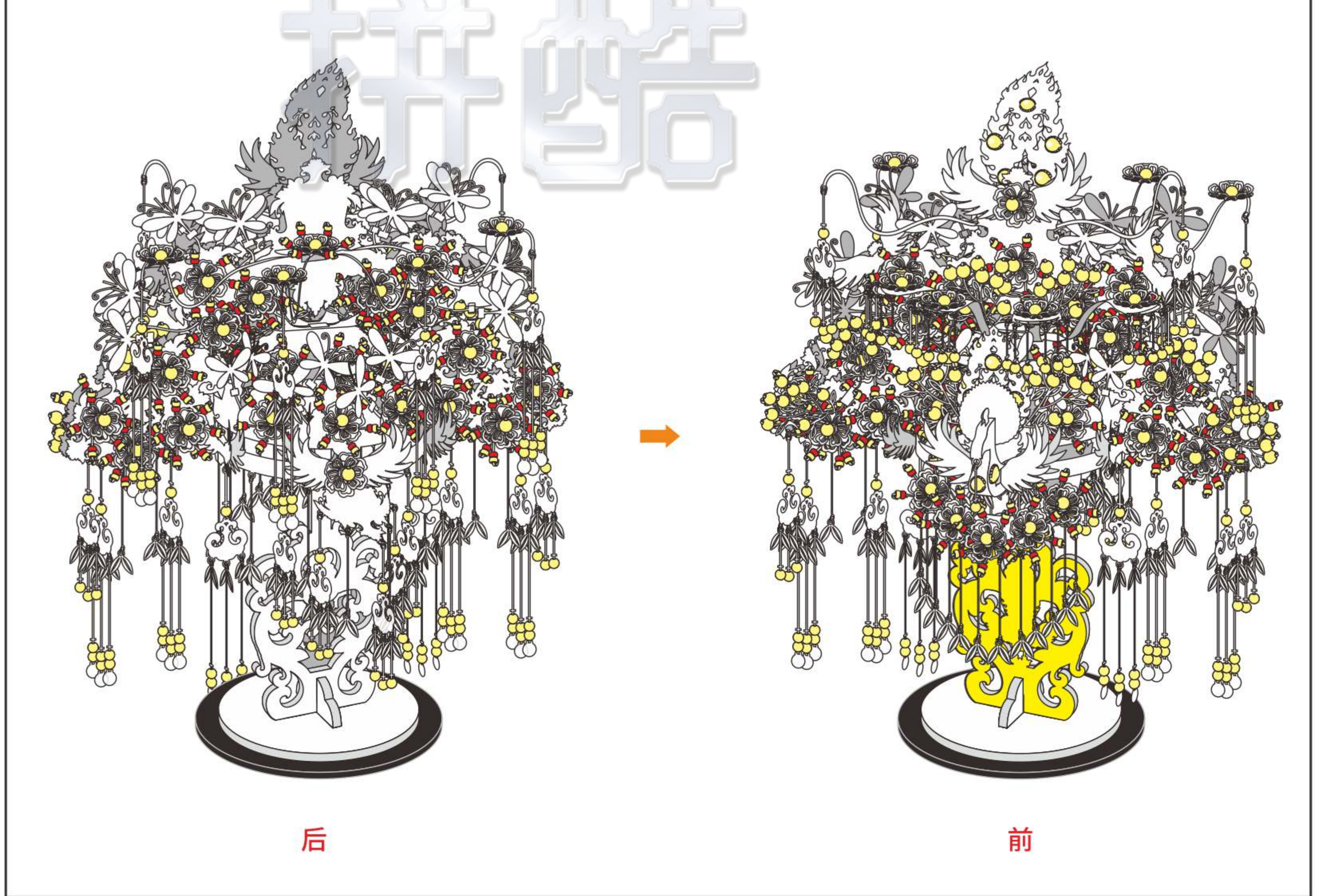
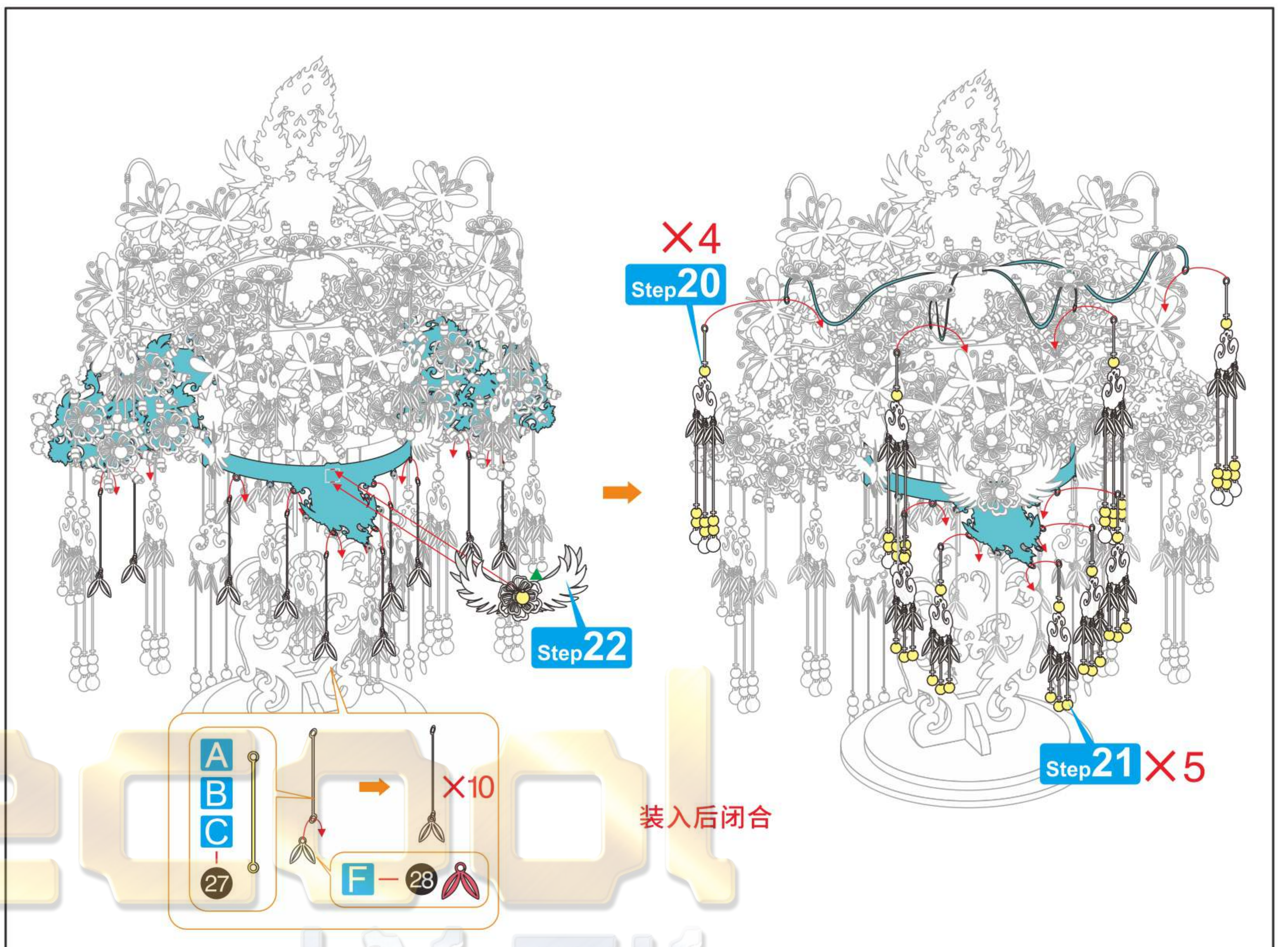
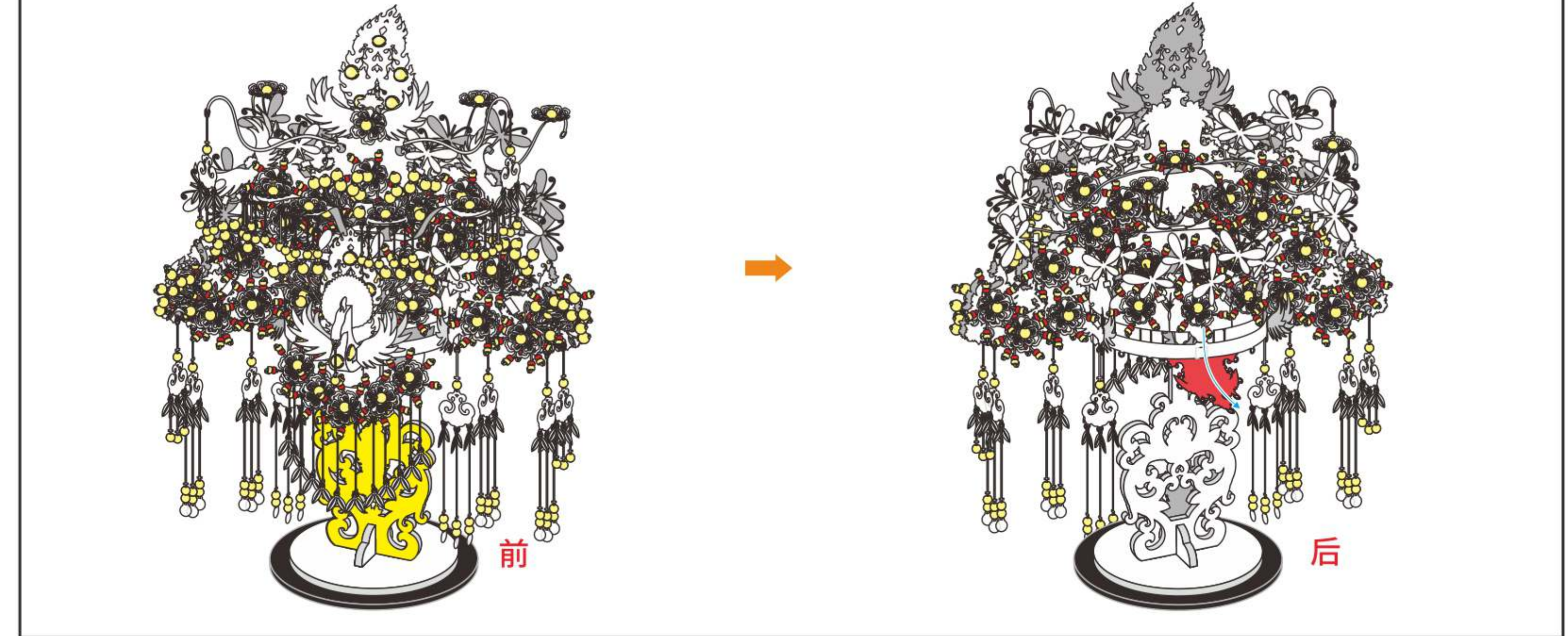
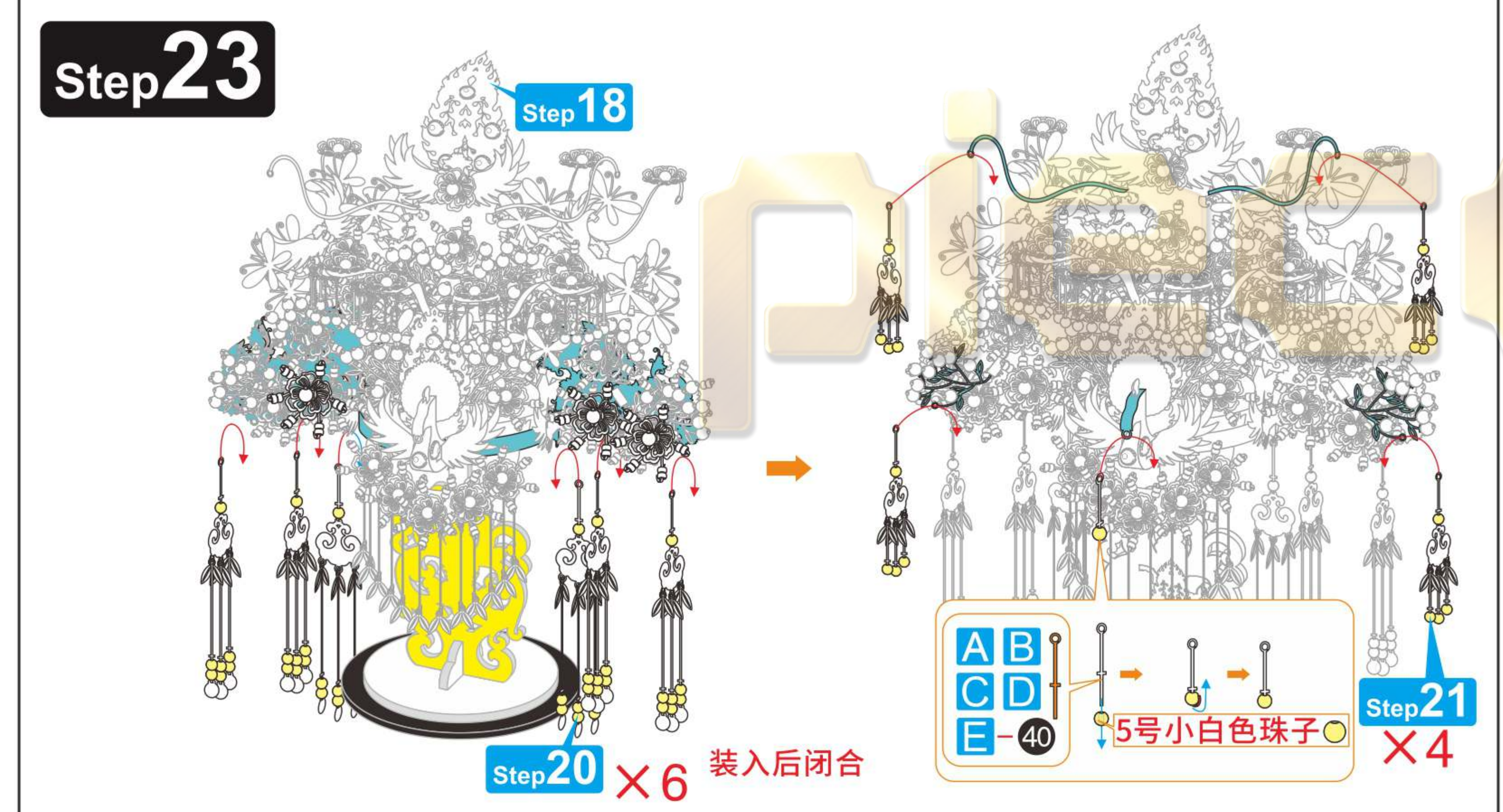
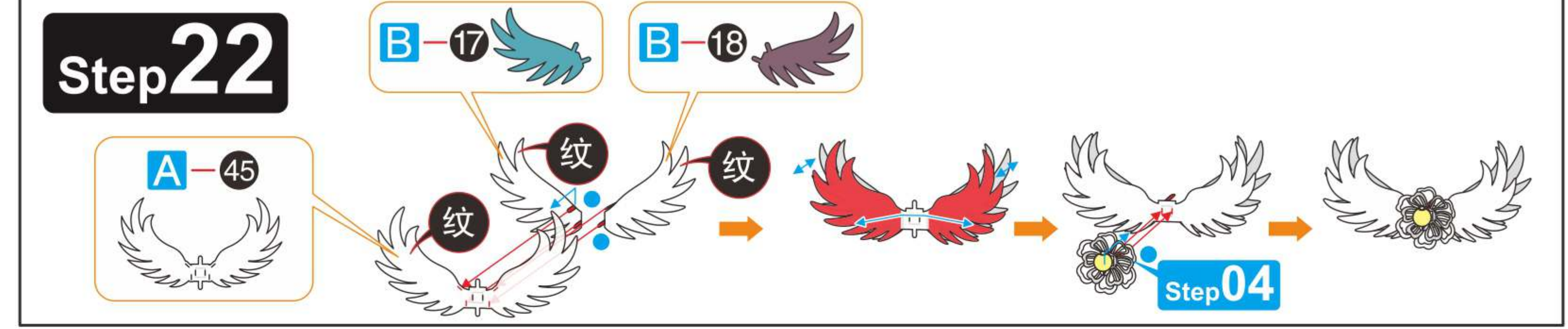
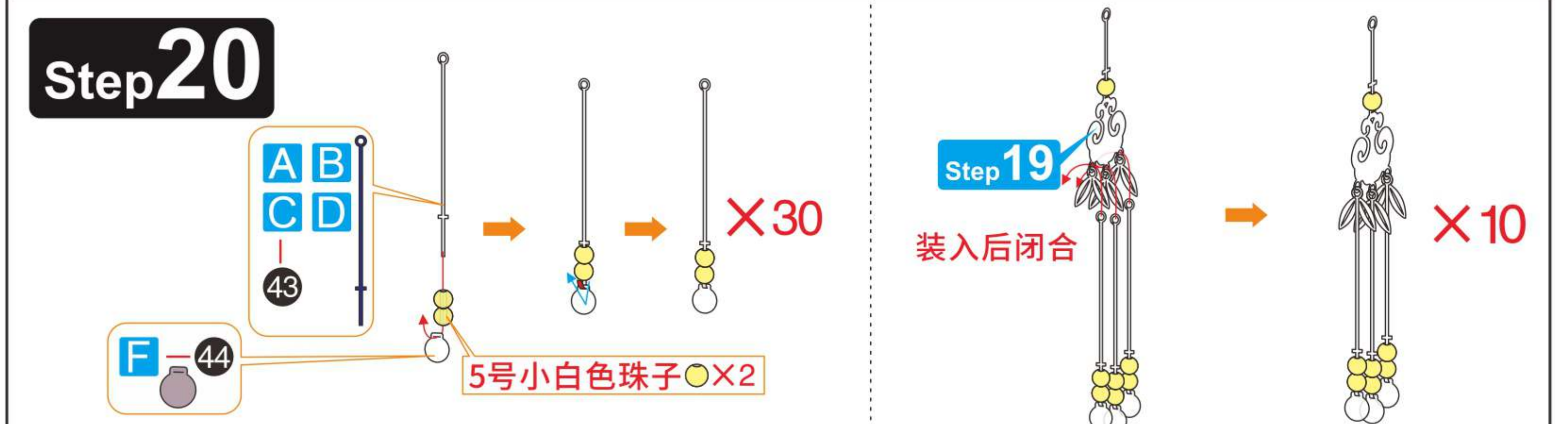
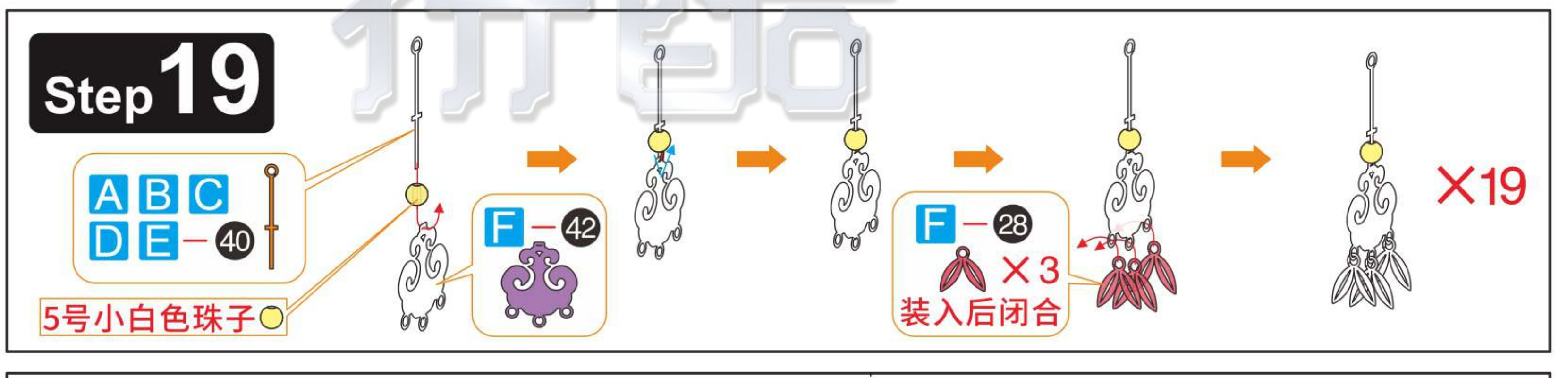
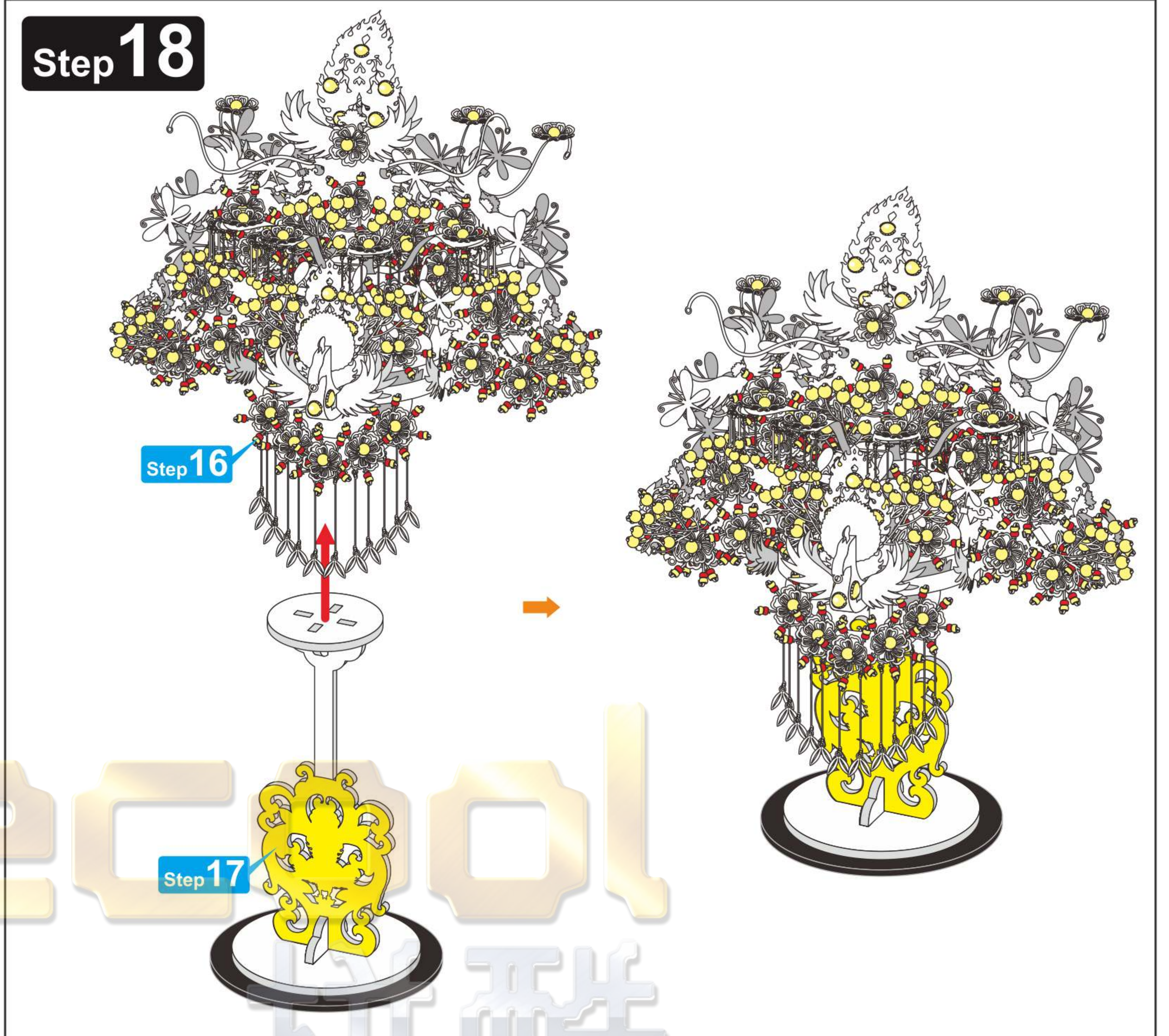
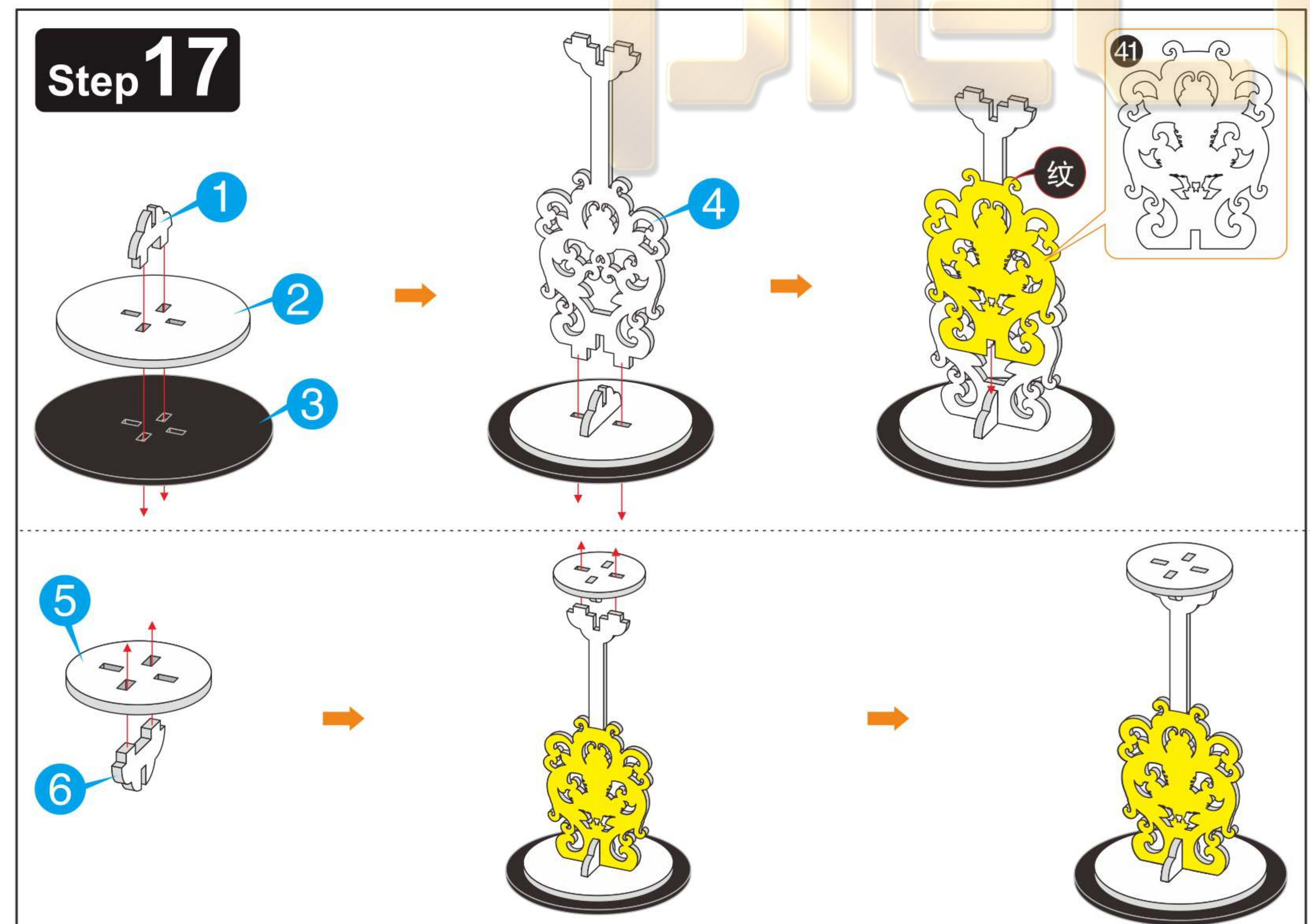
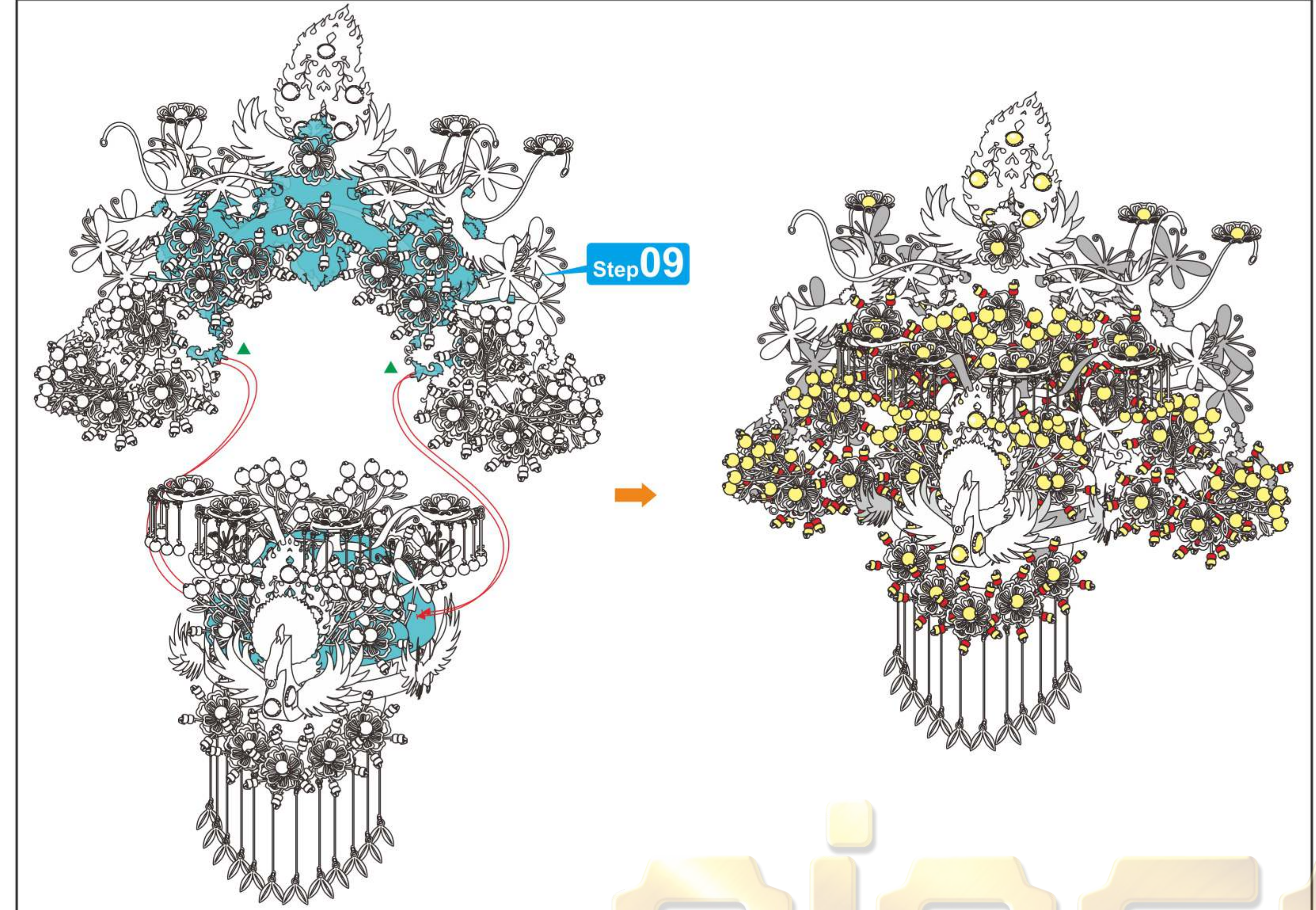

9 10
11 12