

鲲

95000020



CP-ASSY-95000020-A1-20200305

拼装需知

• 拼装辅助工具

积木钳(W)
用于积木粒凸面, 便捷积木粒之间的组合、固定、拆解。

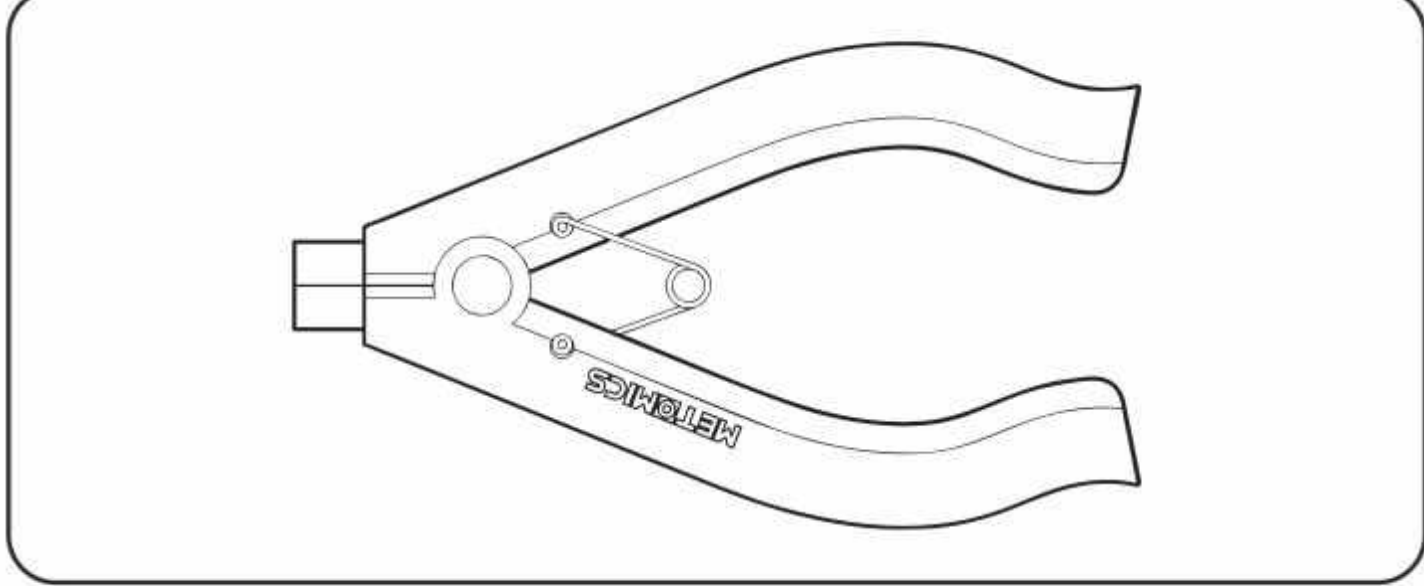

积木钳(M)
用于积木粒凹面, 便捷积木粒之间的组合、固定、拆解。

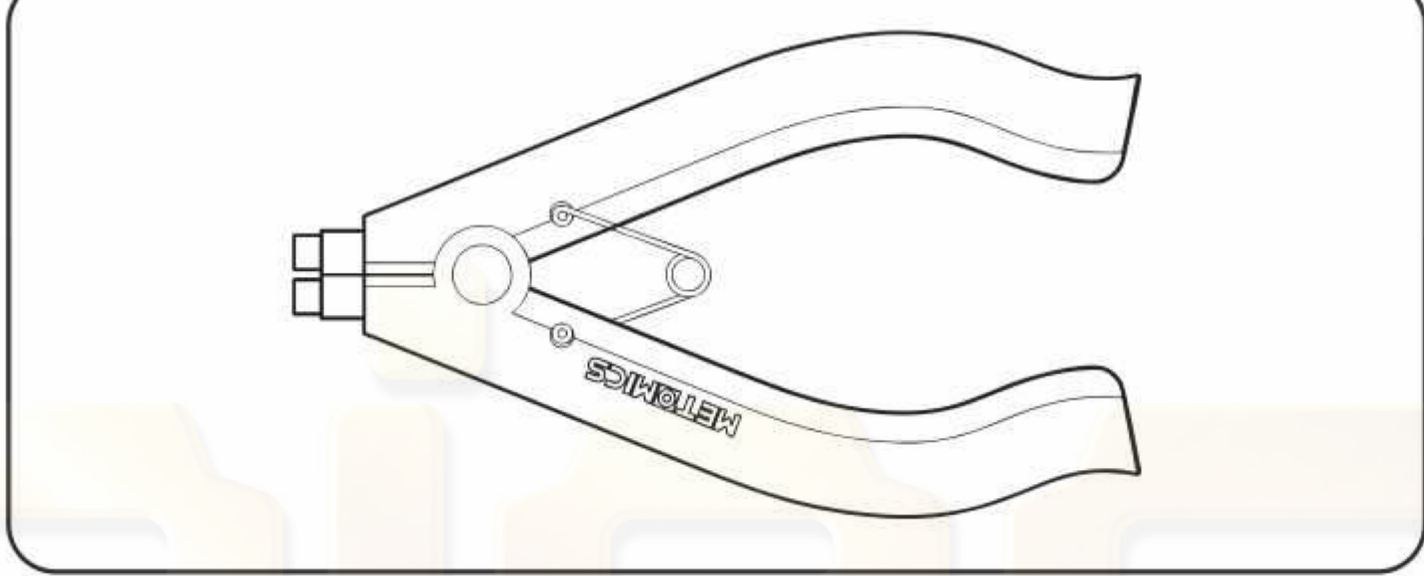

提示: 可另外选购拼装辅助工具(积木钳(W)、积木钳(M)), 用于辅助积木粒间结合更牢固或松动相结合的积木粒, 拼装更省时、省力, 拼装后作品更美观、牢固!

• 识别零件



积木粒凸面:
积木粒上有凸粒的一面。

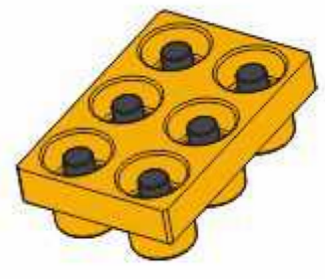

积木粒凹面:
积木粒上有凹孔的一面。

• 拼装方法

1. B积木粒的凹面对准A积木粒的凸面, 按压固定。

2. 积木粒转轴位可旋转。

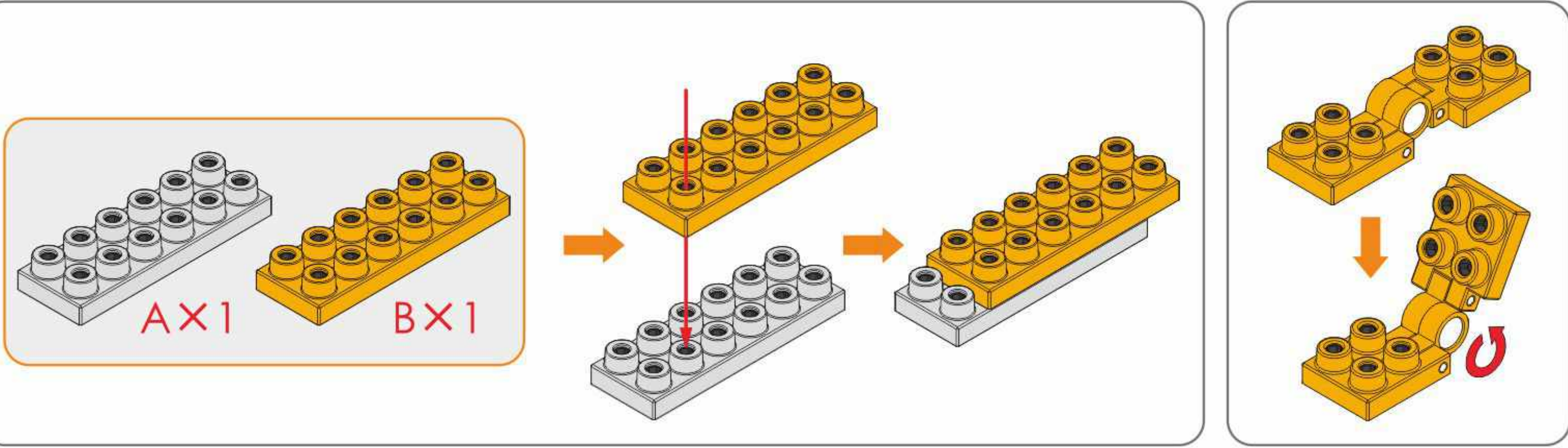

拼装步骤

Step
01

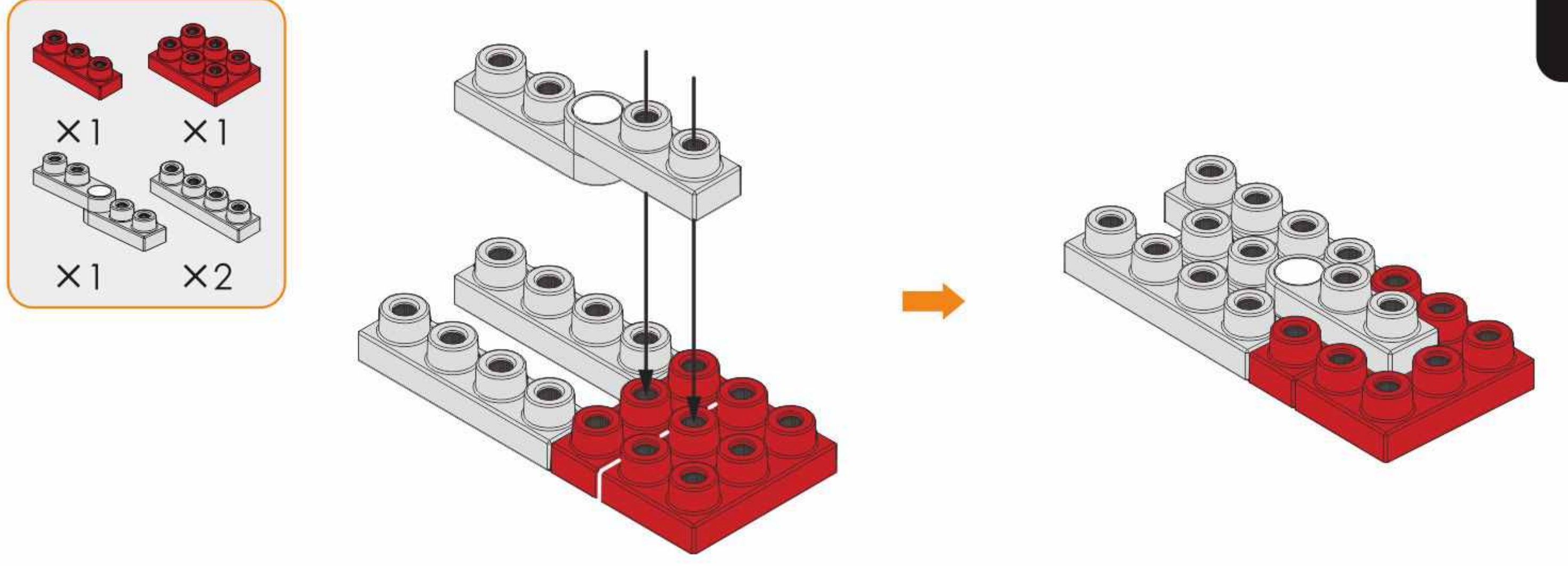

Step
02

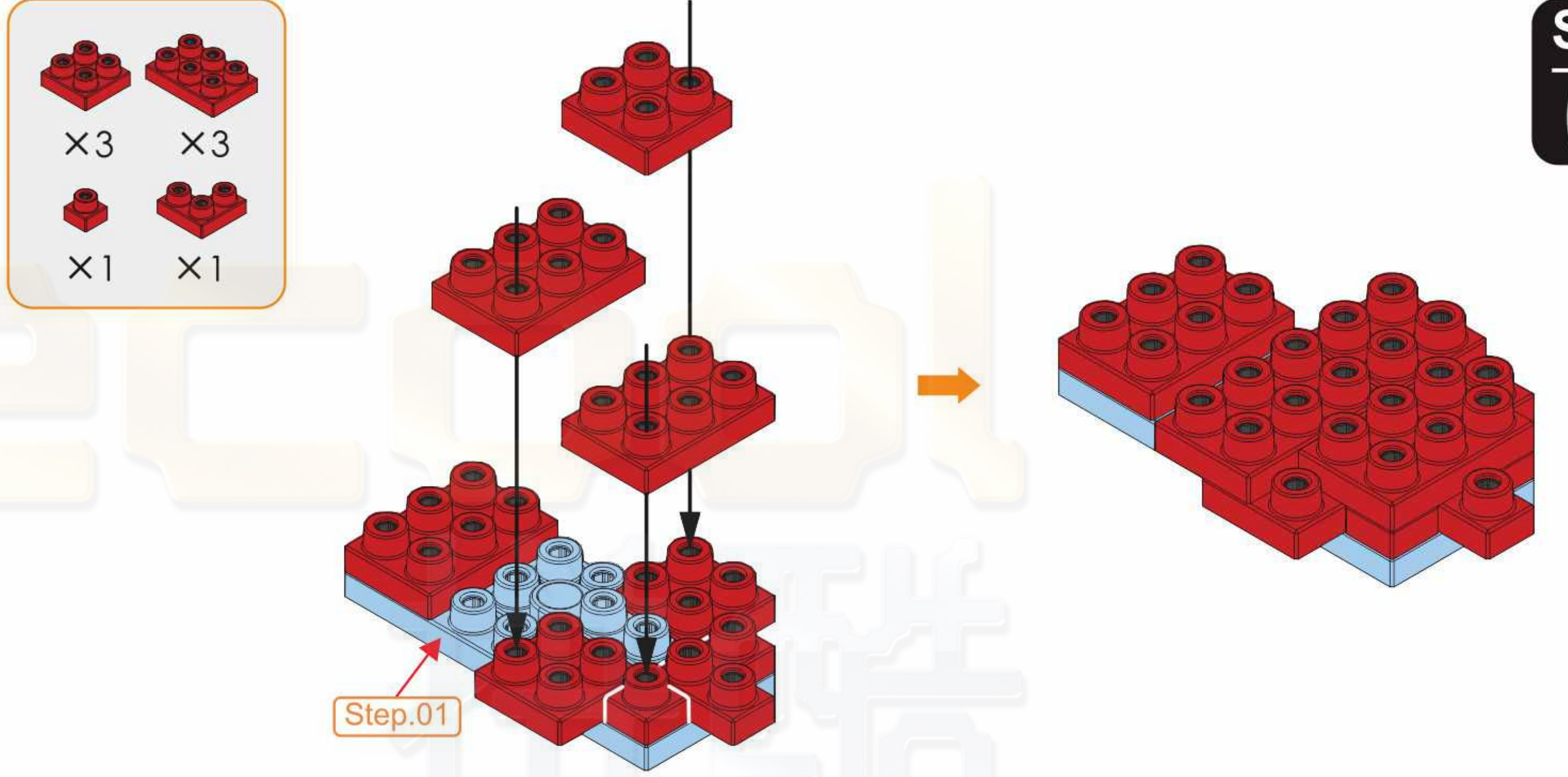

Step
03

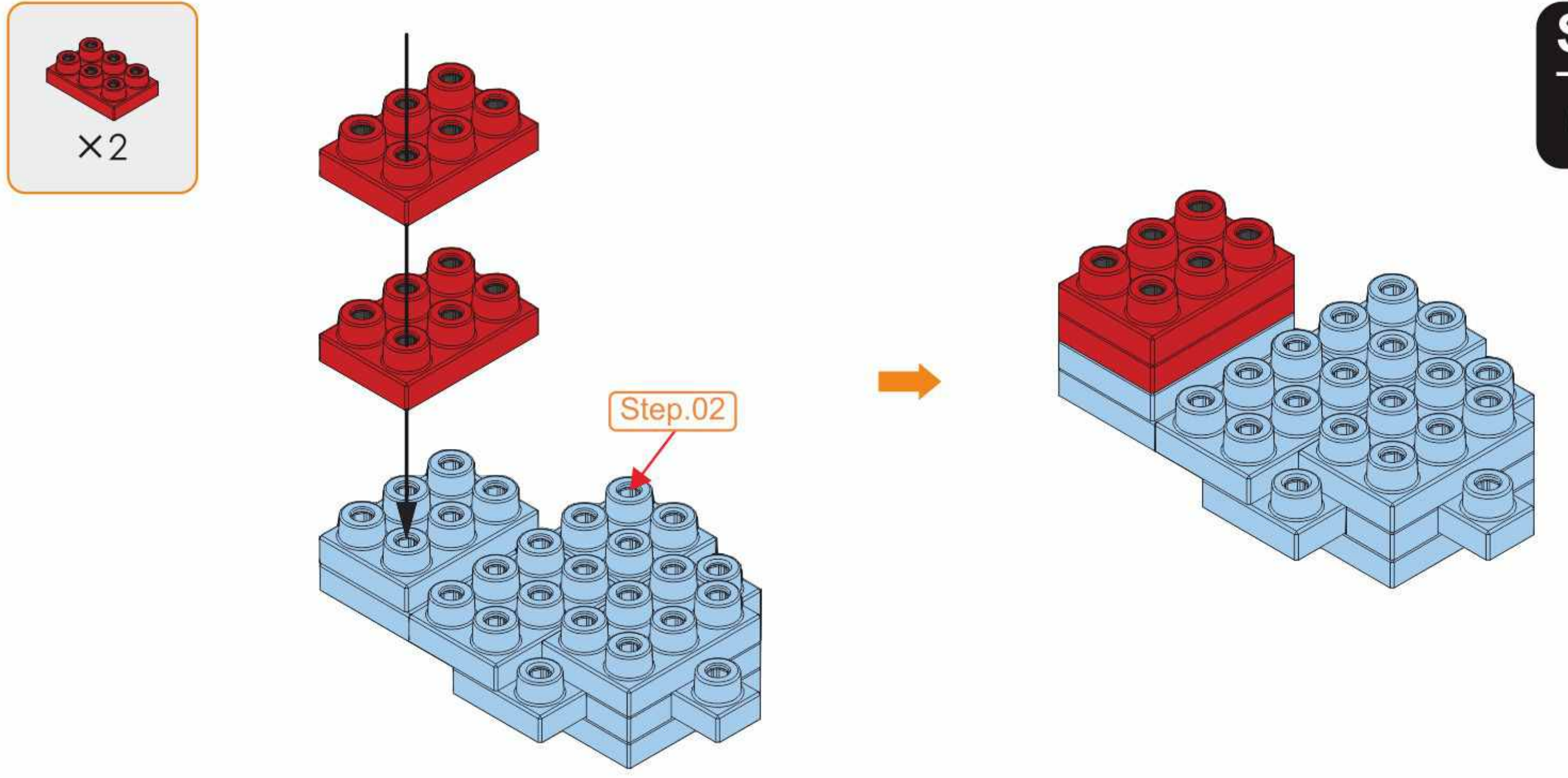

1 2
3 4

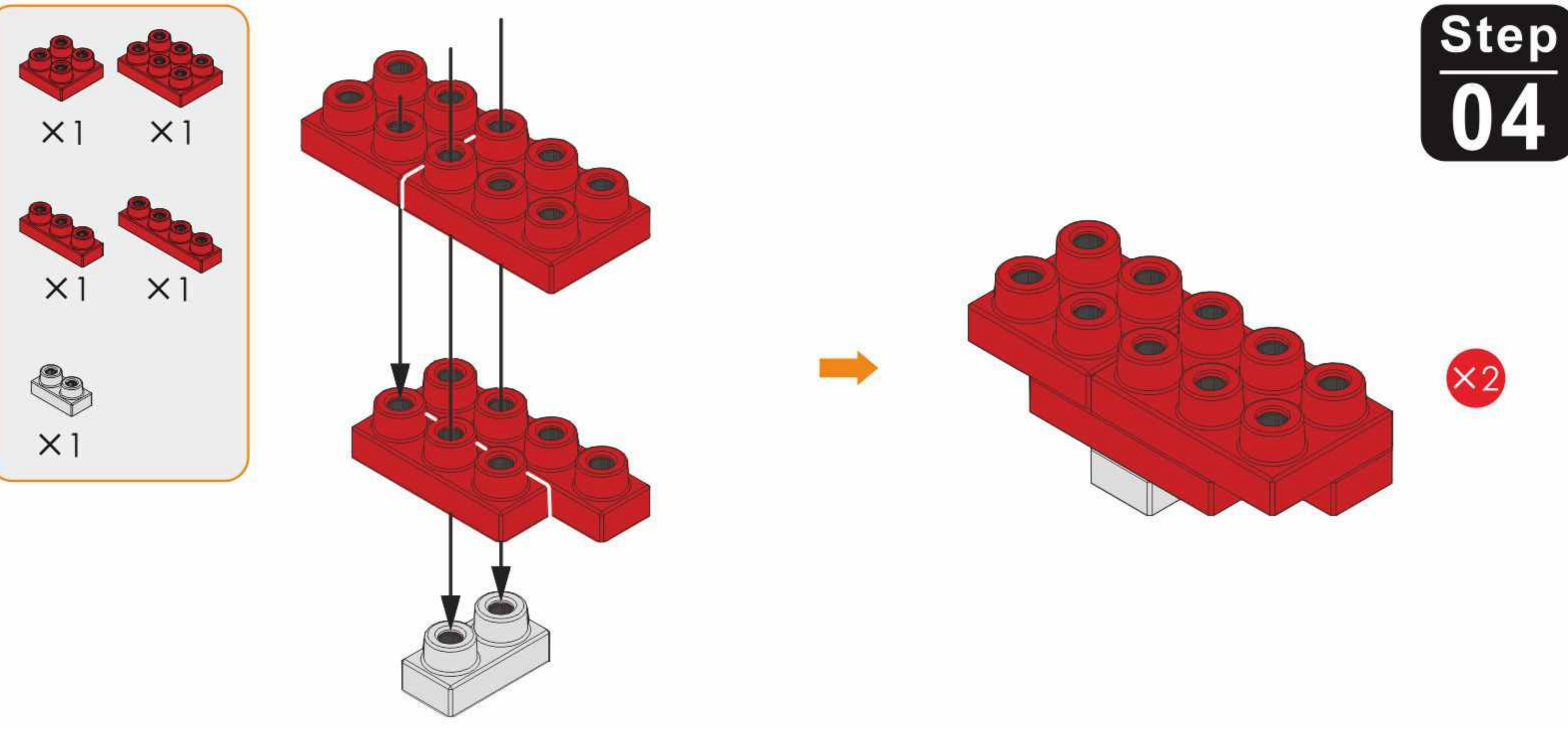

Step
07

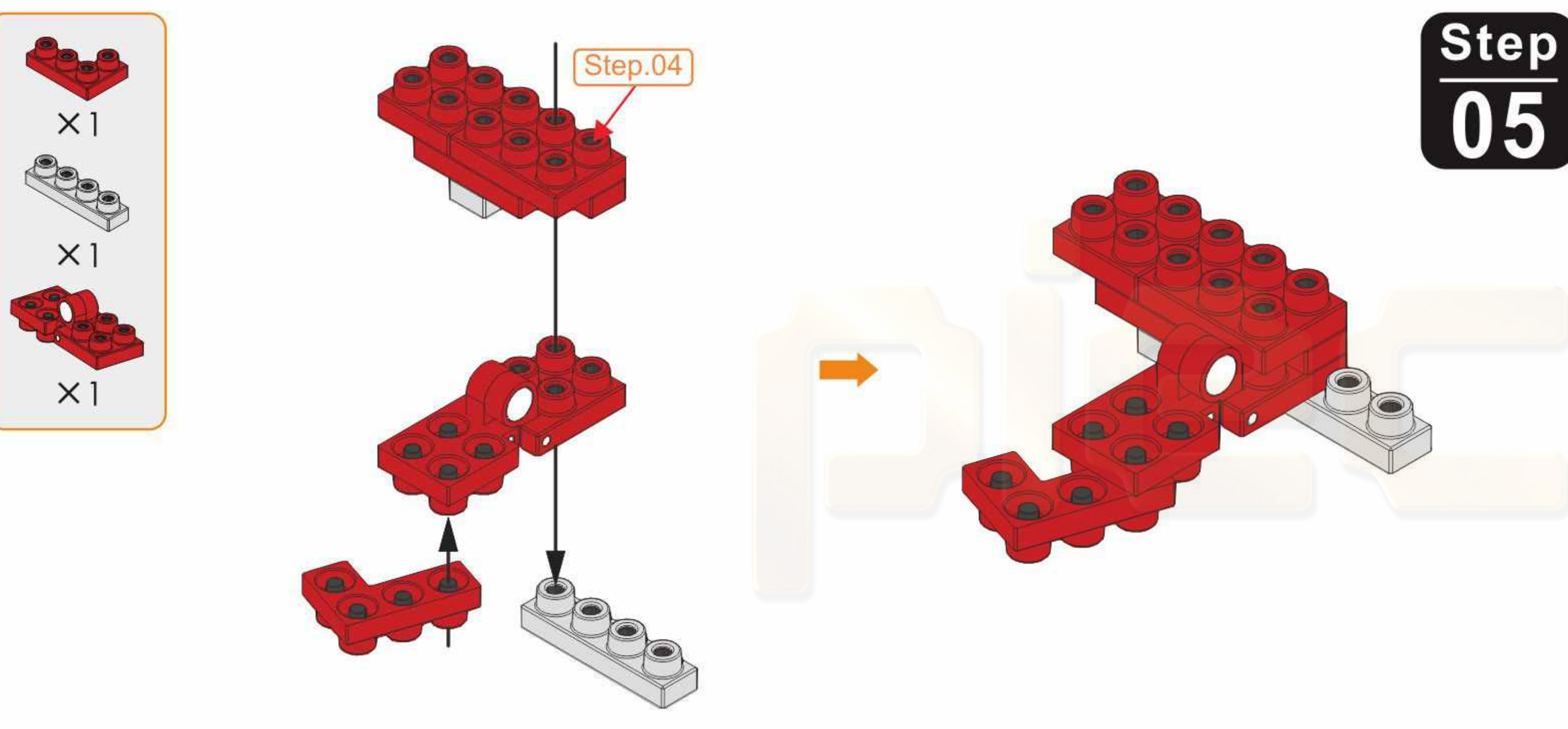
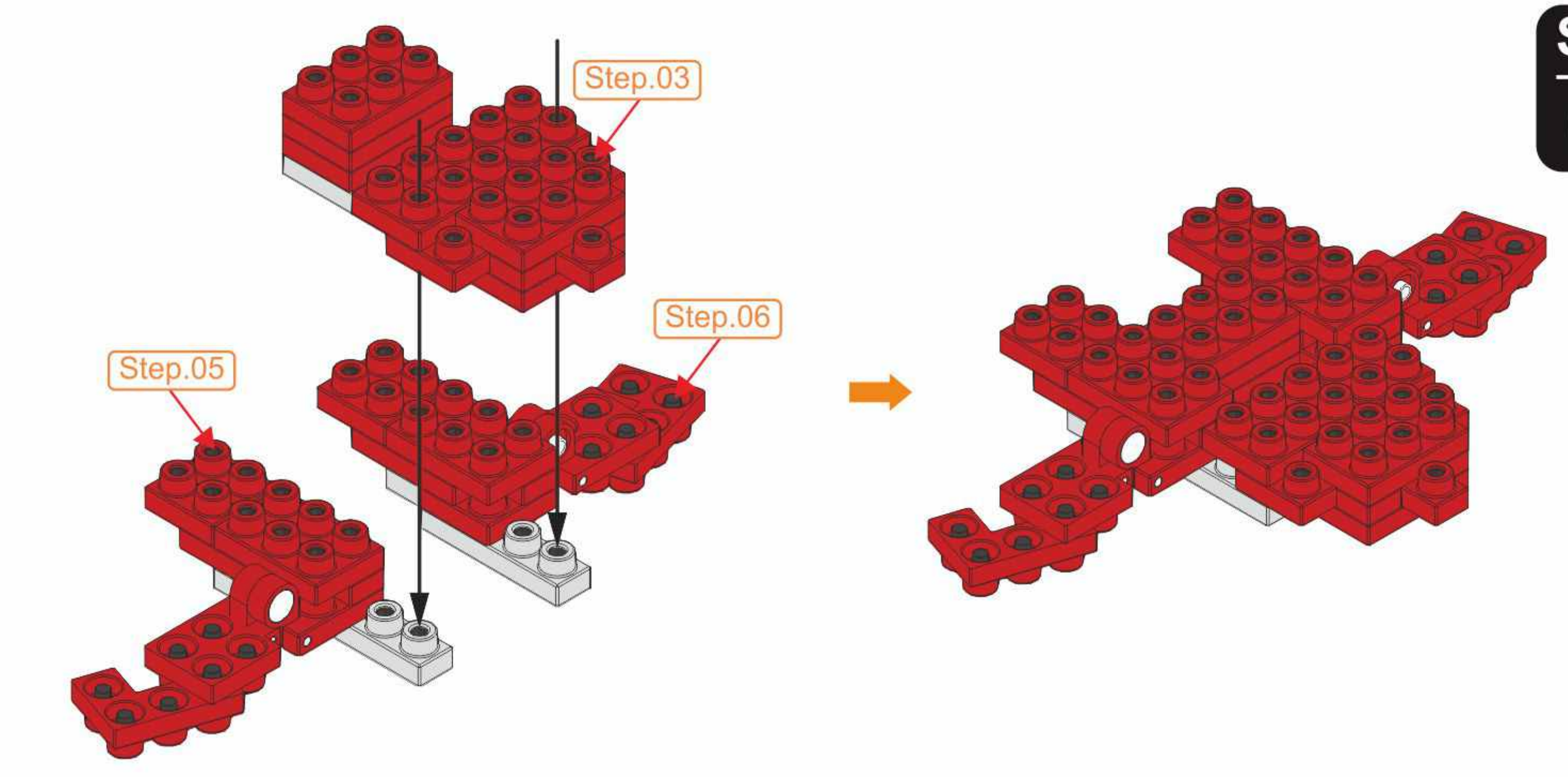

Step
08

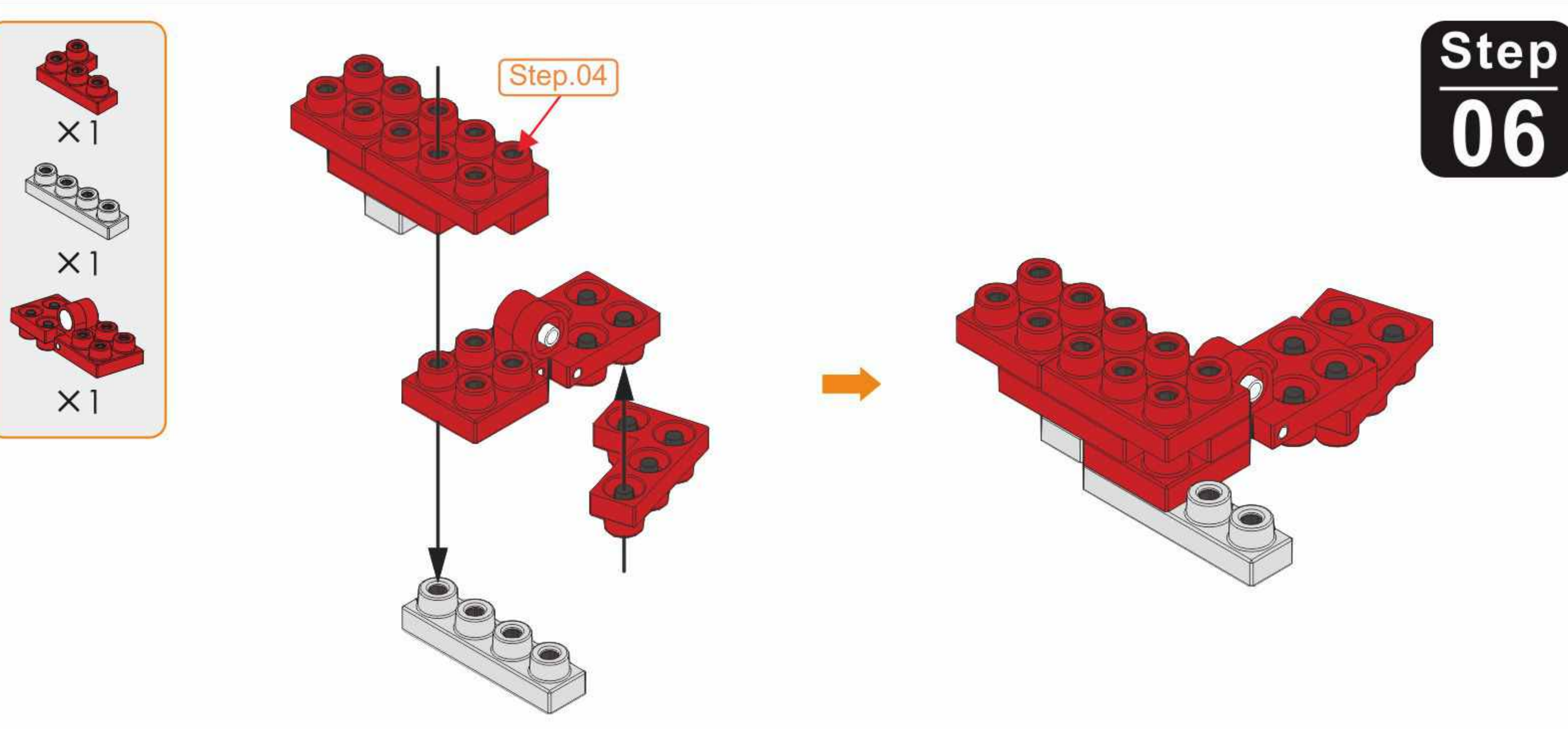
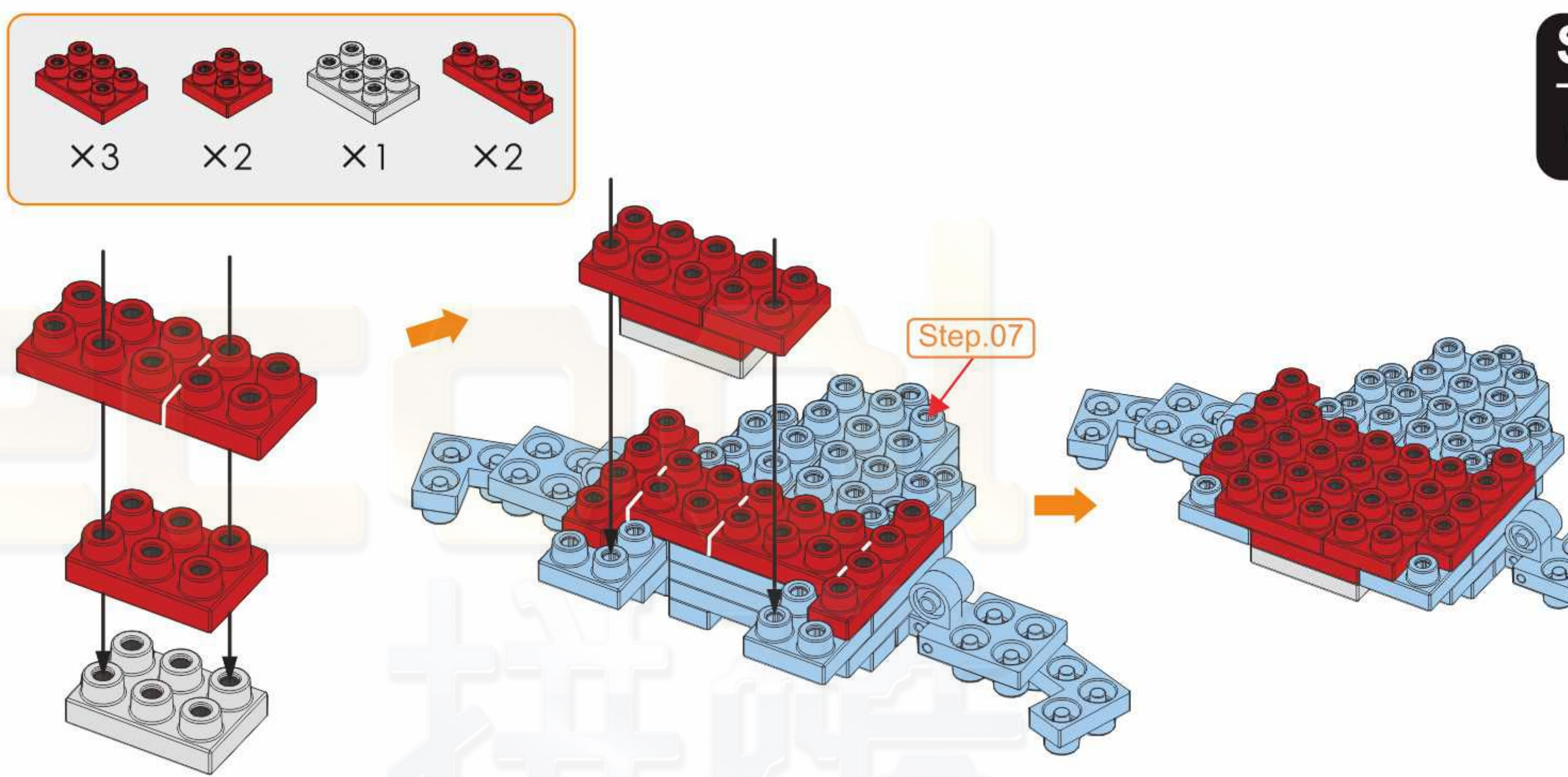

Step
09

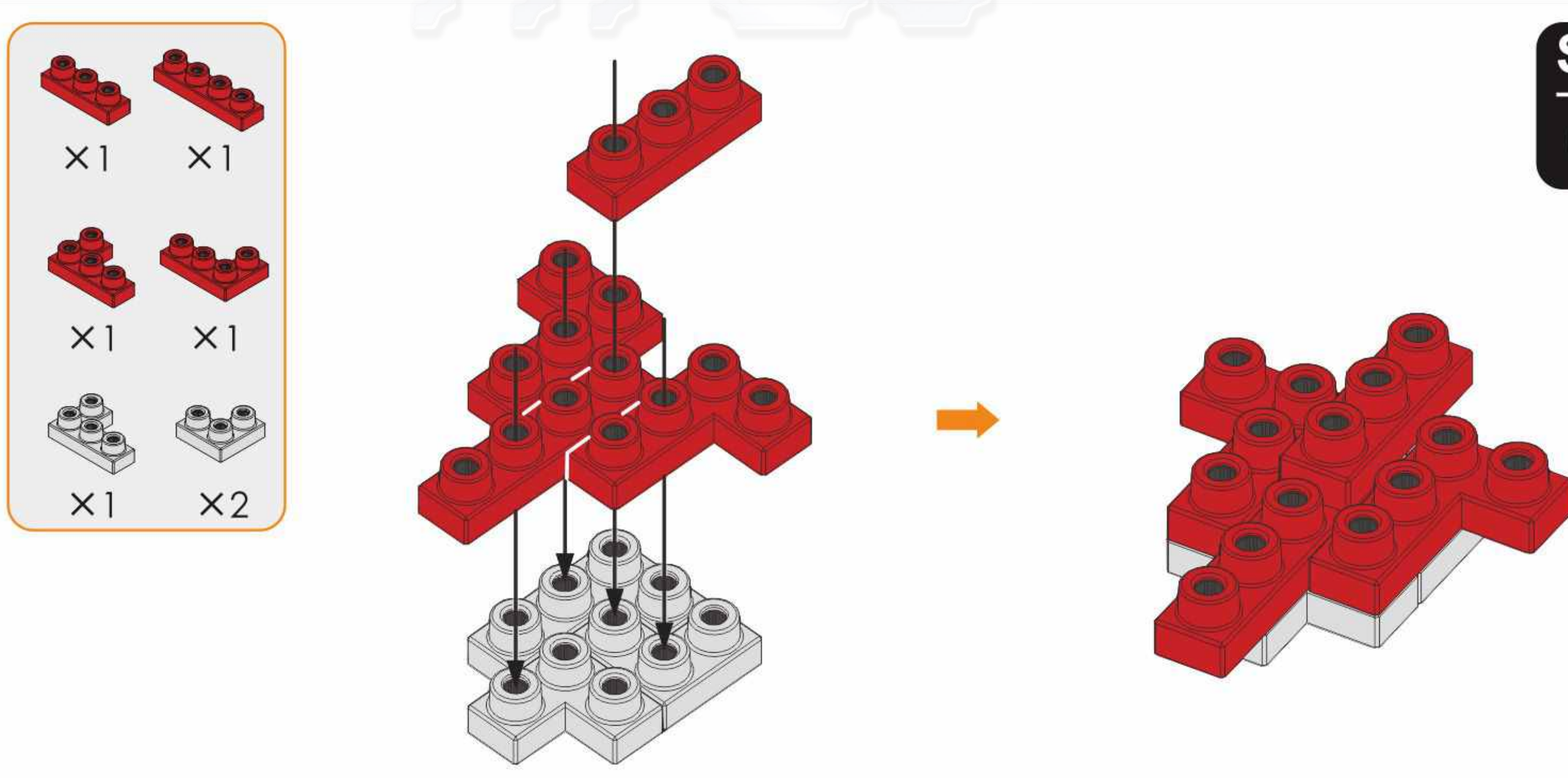

Step 10

- ×1
- ×1
- ×2
- ×1

Step 13

- ×2
- ×2
- ×1
- ×1
- ×1
- ×2

Step 11

Step 14

Step 12

- ×6
- ×2

Step 15

- ×5
- ×4
- ×2

Step 16

- ×2
- ×3
- ×1

Step 17

- ×2
- ×2

Step 22

Step 18

- ×1

Step 19

- ×4

Step 23

Step 20

- ×1
- ×2
- ×2
- ×2

Step 21

- ×1
- ×2

Step 24



www.Pieceecool.com

© WIST PLASTIC & METAL TECHNOLOGY LIMITED. ALL RIGHTS RESERVED.

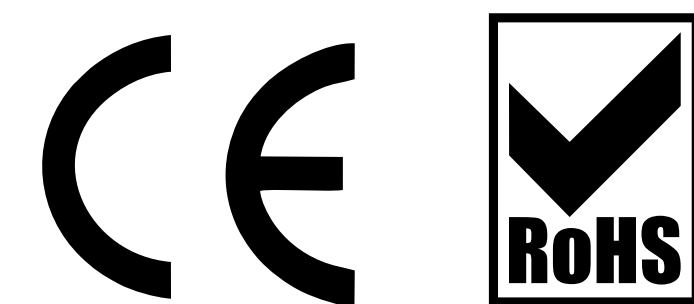

AGES 14+

本产品为金属制品，14岁以下需由成人陪同完成！

© WIST PLASTIC & METAL TECHNOLOGY LIMITED. ALL RIGHTS RESERVED.

说明书批号：2020/3/5

发布日期：20200511