

诸葛亮 卧龙神算
ZHU GE LIANG
Q001



Q001.SMS.20180528.A1

拼前需知

⚠️ 请小心处理金属边料，以防划伤

● 准备工具：

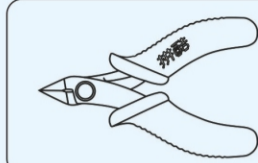

水口钳工具
修剪金属片板件上的零件水口位。

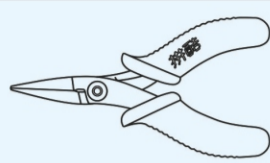

尖嘴钳工具
弯折金属零件上的折叠线和扣点。

建议使用拼酷正品拼装工具（水口钳、尖嘴钳），拼装时更省心、省力，拼装后作品更精细、美观！

● 拼装方法：

a. 取下零件



零件水口位
Nozzle Position
使用水口钳剪断金属零件上的水口，将需要的金属零件从金属片板件取下。

b. 识别零件



扣点 / Insert tab
折叠线 / Fold line
扣孔 / Insert hole
识别金属零件上的扣点、折叠线、扣孔的样子。

c. 折叠零件

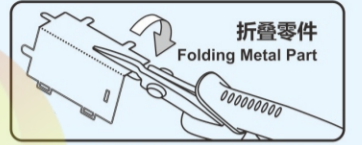

折叠零件
Folding Metal Part
使用尖嘴钳，参照拼装说明书将金属零件折成形状。

d. 固定零件



平折扣点
Bending Tab
● 插入扣孔，平折 90°

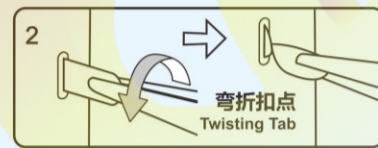

弯折扣点
Twisting Tab
▲ 插入扣孔，旋转 90°

● 注意事项：

- 纹 纹理面
- ! 注意细节
- 非 非纹理面
- 注意片对称

剪金属零件时请剪零件“水口位”，请勿将“扣点”当成“水口位”剪下，每次剪零件时请仅剪当前步骤的零件，切勿一次性将所有零件全部剪下，避免丢失；当遇到折叠线的零件，请注意金属片的正反面及拼折方向，请按照说明书说明的方向，轻剪慢折，最好一次折叠完成，请勿反复折叠，避免零件损坏。

拼装步骤

Step 1

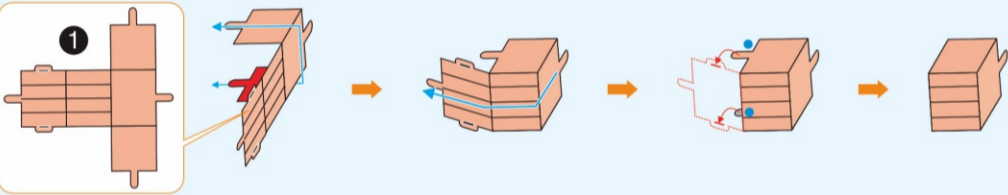

Step 2

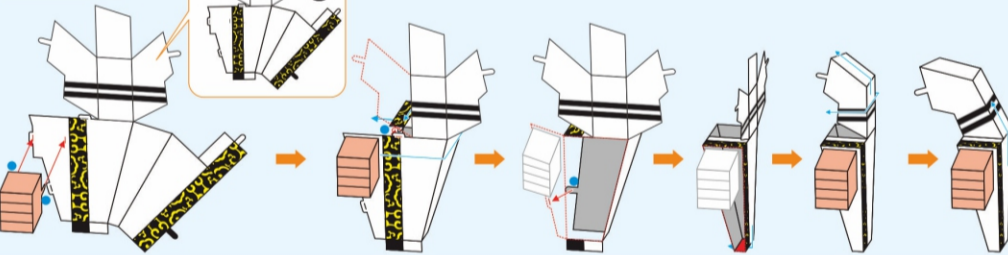

Step 3

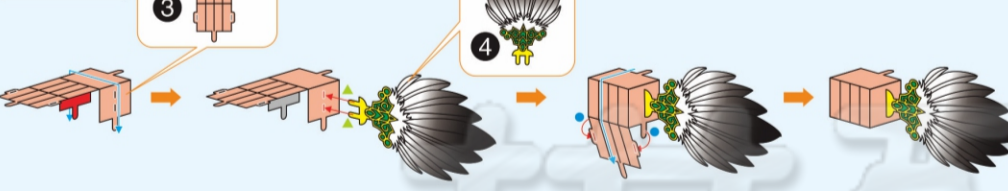

Step 4

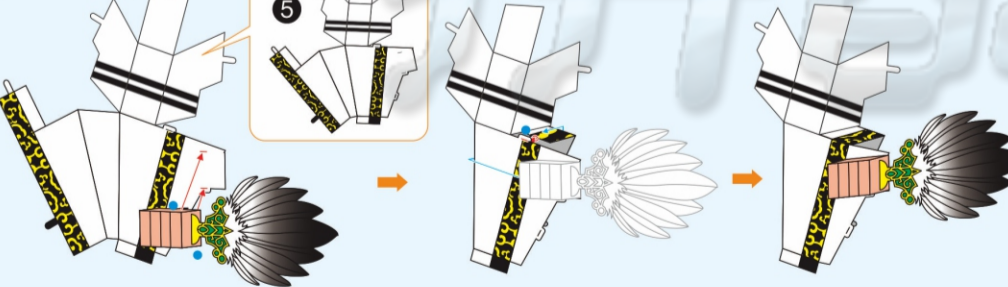

Step 5

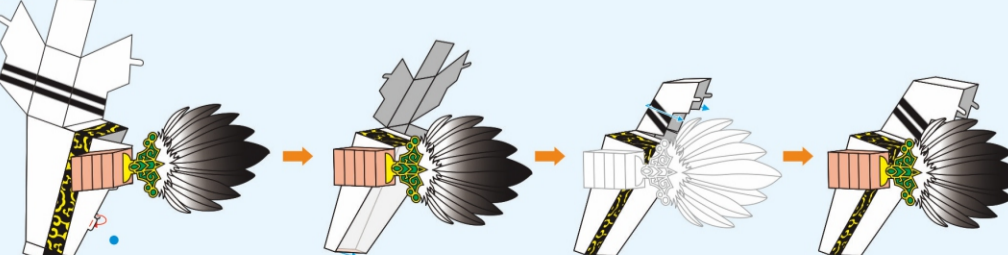

Step 6

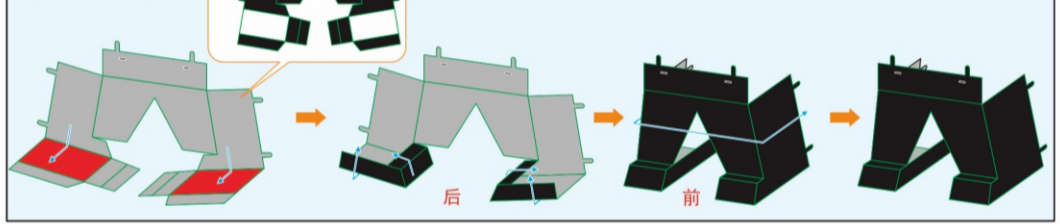

Step 7

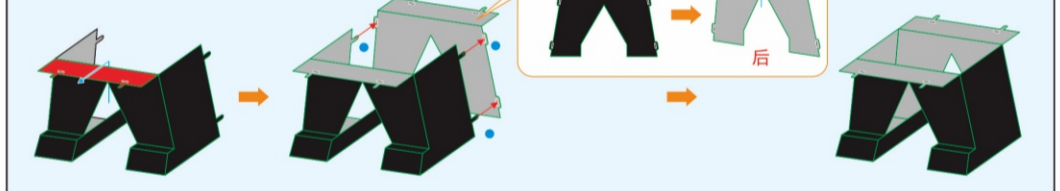

Step 8

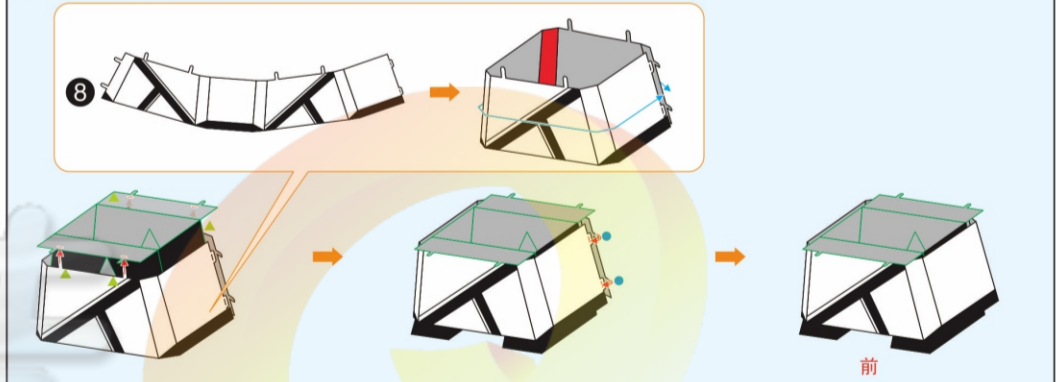

Step 9

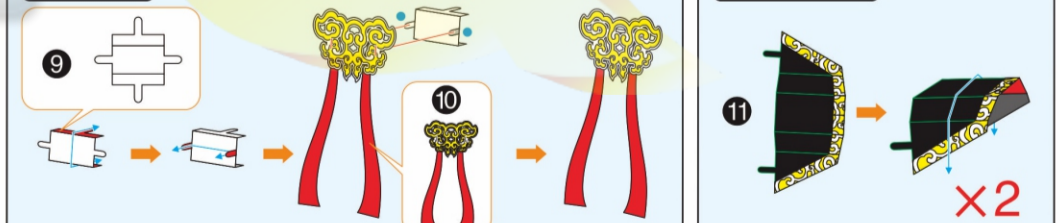

Step 10

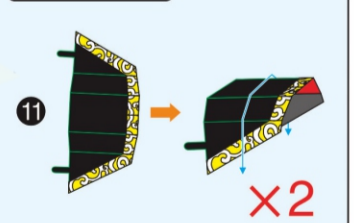

Step 11

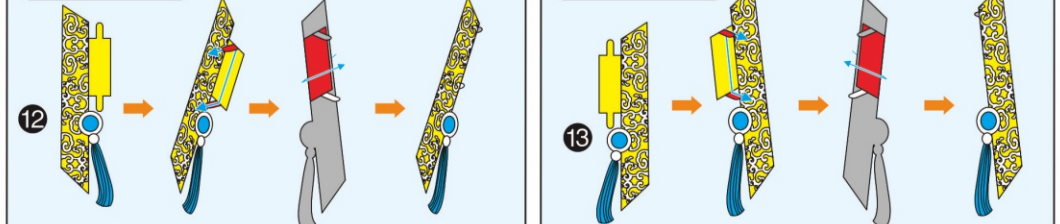

Step 12

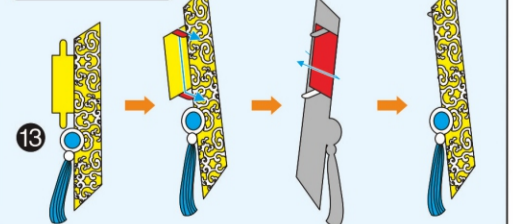

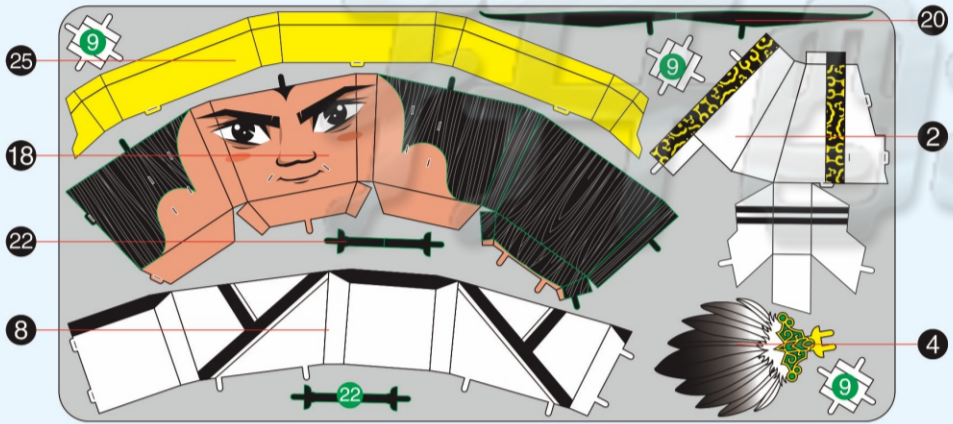
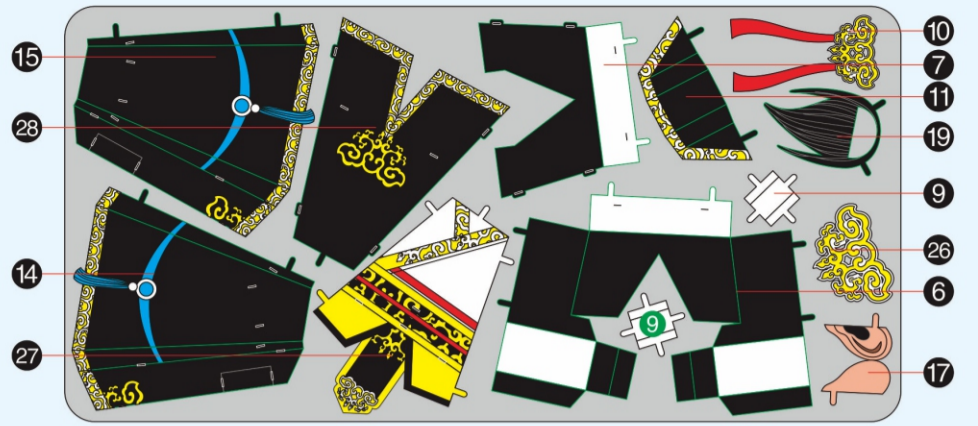
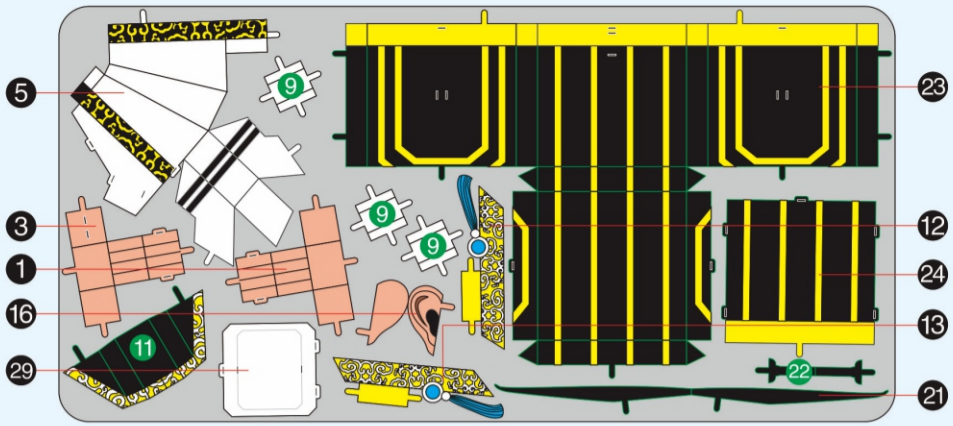

Step 13

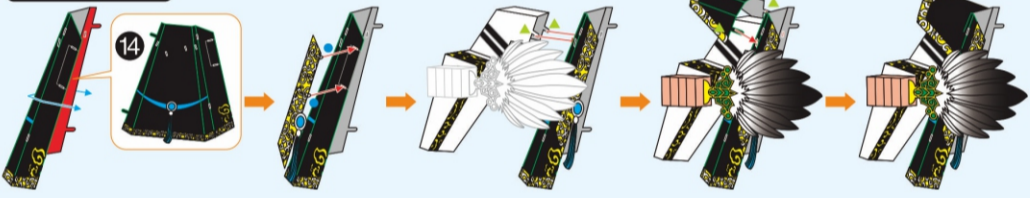

Step 14

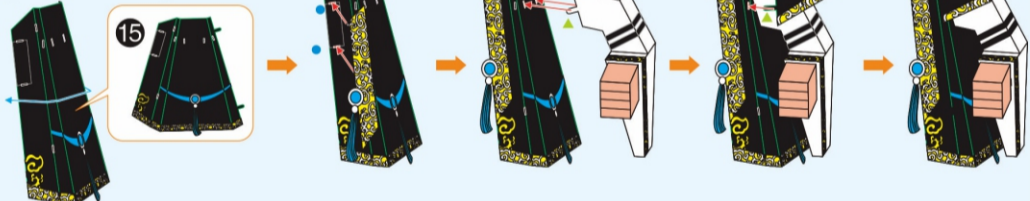

Step 15

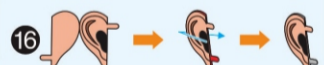

Step 16



Step 17

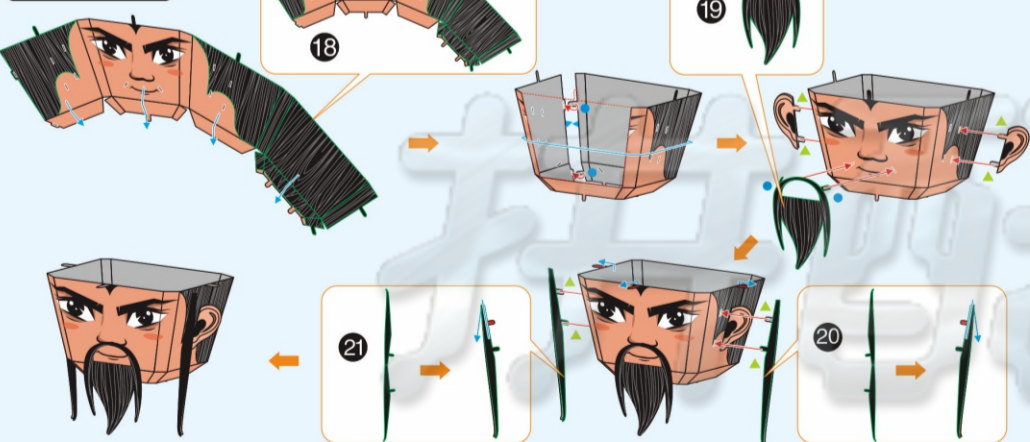

Step 18



Step 19



Step 20

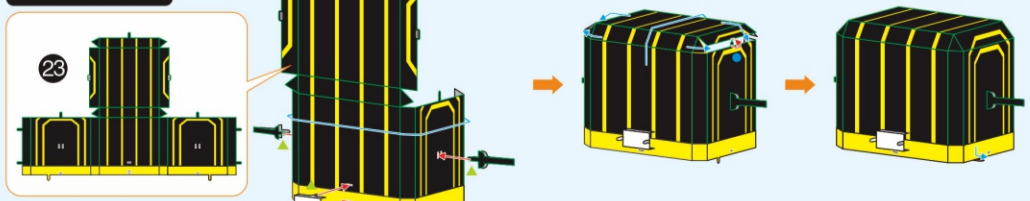

Step 21

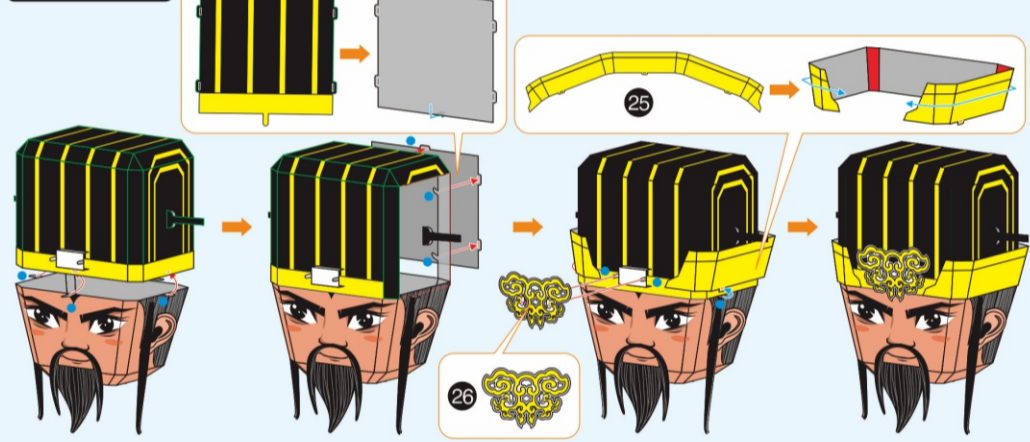

Step 22

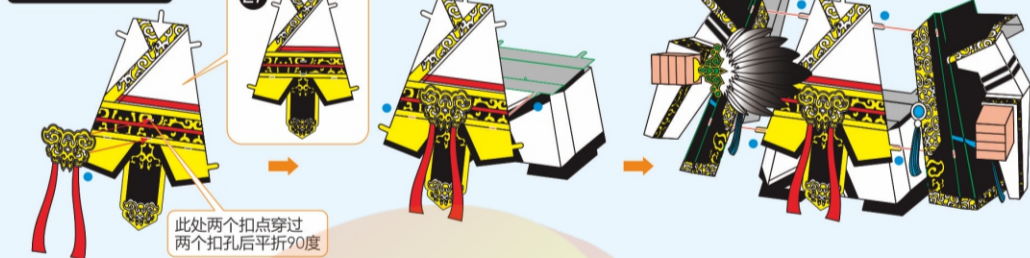

Step 23

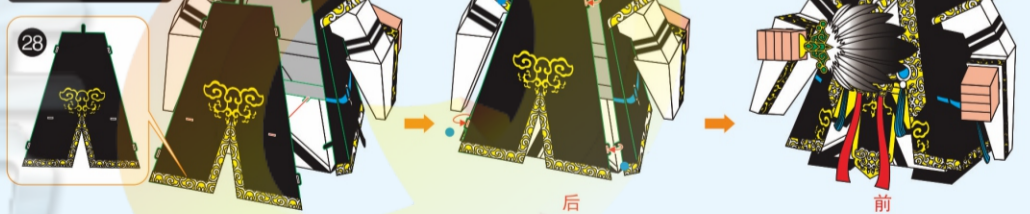

Step 24

